

DRAFT

Phase 1: Archaeological Documentation for the  
Archaeology Advisory Board of the Historic House Trust  
of New York City

FALL 2010

Prepared for the Historic House Trust of New York City  
By Ashley Bettis, Archaeology Intern, February 2010 – Present

## Table of Contents

Abstract.....	Page 3
Introduction.....	Page 3
Documentation.....	Page 3-4
Conclusions & Recommendations...	Page 4-13
Appendix A.....	Page 14
Appendix B.....	Page 36
References.....	Page 41-42

## List of Figures

Figure 1: Master List.....	Page 14-25
Figure 2: Bartow-Pell Mansion Archaeological Excavations Map (Rough Draft) .....	Page 26
Figure 3: Conference House Archaeological Excavations Map 1 of 2 (Rough Draft).	Page 27
Figure 4: Conference House Archaeological Excavations Map 2 of 2 (Rough Draft)	Page 28
Figure 5: Dyckman Farmhouse Archaeological Excavations Map (Rough Draft)....	Page 29
Figure 6: Gracie Mansion Archaeological Excavations Map (Rough Draft).....	Page 30
Figure 7: King Manor Archaeological Excavations Map (Rough Draft).....	Page 31
Figure 8: Morris-Jumel Mansion Archaeological Excavations Map (Rough Draft)...	Page 32
Figure 9: Queens County Farm Museum Archaeological Excavations Map (Rough Draft)....	Page 33
Figure 10: Van Cortlandt Mansion Archaeological Excavations Map (Rough Draft) .	Page 34
Figure 11: Wyckoff House Archaeological Excavations Map (Rough Draft).....	Page 35
Figure 12: Suggested Database Organization.....	Page 36
Figure 1B: Table of Document Frequency by House.....	Page 37
Figure 2B: Chart of the Percentage of Documents by House.....	Page 38
Figure 3B: Table of Document Type Frequency.....	Page 39
Figure 4B: Chart of Document Type Frequency.....	Page 40

## **ABSTRACT**

In 2010 the Historic House Trust of New York City established the Archaeology Advisory Board to improve and consult on archaeological work done at the twenty-three houses within the Trust. With a great deal of archaeology having taken place at many of the houses the first step to improving the archaeological system, is that all information pertaining to archaeology at the houses be organized and easily accessible. This will make future archaeological efforts more effective and create a more richly informative history of the houses.

## **INTRODUCTION**

In February 2010, the Historic House Trust of New York City employed Ashley Bettis, as an intern, to gather all documentation of archaeology that has occurred at the houses within the Trust's collection. The goal was to attain a "Master List" of all the aforesaid documentation, along with copies of the documents. These documents were then to be organized digitally with the prospect of creating an online database to store such information in the near future.

## **DOCUMENTATION**

The process of finding documentation involved many resources. Over the course of this project three hundred and twenty documents were collected, with the Historic House Trust having only seventy prior to the project. It was through correspondence and visits with the employees of the houses, the Landmarks Preservation Commission, the New York Public

Library, archaeologists and other specialists (See References), that the other two hundred and fifty were obtained.

A Master List was created that lists each document by “House,” “Title,” “Document Type,” “Date,” and “Author.” The List also includes notes about the document, the location where a hard copy can be found, and whether the document was made into a digital file. See Figure 1 in the Appendix for a copy of the Master List. Documents that were digitized (total 2.07GB in size) and are saved in a folder on the Historic House Trust’s computer drive.

After completing the Master List and uploading the documents into digital files, the information was used to create rough “Maps of Archaeological Excavations” where archaeology had generally occurred for each house and its surrounding area. The last two columns of the Master List account for these maps. The former, “to be mapped?” column indicates whether the document was used in the creation of the maps. The latter, “map number,” gives each document a number linking it to its project area in its respective map. For example, if a report on archaeology at Bartow-Pell Mansion has a map number of 4, then the Bartow-Pell Map of Archaeological Excavations designates the area detailed in that report with a number 4. The maps were uploaded into a file on the Historic House Trust’s computer drive and total 4.77MB in size. See Figures 2 to 11 in the Appendix for copies of these maps. In the near future these rough maps will be converted to the computer program CAD so that they can be updated as needed.

## **CONCLUSION & RECOMMENDATIONS**

It is the suggestion of the author that Phase 2 of this project be the creation of an archaeological database for reference to all archaeology past, present and future that occur at any



of the houses within the Trust. When such a database is created, it should account for the various types of documents that have been digitized. For a suggested organization of the documents see Figure 12 in the Appendix. It would also be prudent to organize that data by Borough, House, Title, Date, and Author.

Once a database has been created, it will be a useful tool to many facets of the archaeological process for the Historic House Trust. It will allow the user to research archaeological work relative to specific houses as well individuals involved with and procedures taken in the process of archaeology at the houses. It will also allow the user to determine areas of potential sensitivity and those that have been exhausted.

At present, the houses that documentation has been accounted for are; the Alice Austen House, the Bartow-Pell Mansion, the Conference House, the Dyckman Farmhouse, Historic Richmond Town, King Manor, Kingsland Homestead, the Lott House, Merchant's House Museum, Morris-Jumel Mansion, Queens County Farm Museum, Van Cortlandt Manor, and the Wyckoff House. There have been a few houses for which archaeological documentation could not be found, usually due to the house having been moved from its original location. The houses for which documentation could not be found are; the Bowne House, Edgar Allen Poe Cottage, Lefferts Historic House Museum, Lewis H. Latimer House, Little Red Lighthouse, Old Stone House, Seguin Mansion, Swedish Cottage Marionette Theatre, and the Valentine-Varian House.

The following is a chart listing the houses, whether or not documentation is present, and what if any areas are thought to be potentially sensitive. After this chart is a summary of some of the archaeological work done at the house, the findings of the work, and any recommendations specified in reports.

House	Documentation Present?	Is The Area/ What Areas Are of Particular Significance?
Alice Austen House	Yes	Hylan Blvd, McFarlane-Bredt House, Site of Wharf/Bulkhead, Greenhouses, Site of Gardener's Cottage.
Bartow-Pell Mansion	Yes	Excavations at a depth deeper than 2 feet .
Bowne House	No	Yes
Conference House	Yes	Yes
Dyckman House	Yes	Yes
Edgar Allen Poe Cottage	No	No
Gracie Mansion	Yes	Yes
Hendrick I. Lott House	Yes	The area under the existing garage.
Historic Richmond Town	Yes	Yes
King Manor	Yes	Yes
Kingsland Homestead	Yes	Yes
Lefferts Historic House	No	No
Lewis H. Latimer House	No	No
Little Red Lighthouse	No	No
Merchants House Museum	Yes	No
Morris-Jumel Mansion	Yes	Yes
Old Stone House	No	No
Queens County Farm Museum	Yes	Yes
Seguine Mansion	No	Yes
Swedish Cottage Marionette Theatre	No	No
Valentine-Varian House	No	No
Van Cortlandt House Museum	Yes	Yes
Wyckoff Farmhouse Museum & Education Center	Yes	Yes

### Alice Austen House

The Alice Austen House's sensitivity report from 1990, entitled "Archaeological Investigations," by Peter Gisolfi Associates, points to various areas of sensitivity in the surrounding area of the house. At present, there is no known archaeological work that has

occurred on the site. The sensitivity report notes that there is “potential archaeological sensitivity throughout [the Alice Austen Park].”(Peter Gisolfi Associates, p.74) It also claims that the area south of Hyman Boulevard is “of particular concern regarding prehistoric or early contact Native American sites or artifacts and historical structures now or once standing.”(Peter Gisolfi Associates, p.74) There is also a map within the report, Exhibit 47, entitled “Archaeological Sensitivity Model.” It points to the McFarlane-Bredt House and the “Site of Wharf/Bulkhead” as having “Possible Pre-historic (Native American) Sensitivity.”(Peter Gisolfi Associates, p.79) The map also points to areas of “Potential Historical Sensitivity” including; the McFarlane-Bredt House, Greenhouses, Site of Wharf/Bulkhead, Site of Gardener’s Cottage. (Peter Gisolfi Associates, p.79)

### **Bartow-Pell Mansion**

The Bartow-Pell Mansion has had various archaeological monitoring and work done in the areas surrounding it. The work done included the carriage house, monitoring of the path leading from the main drive to the west side of the mansion, fence line and septic field monitoring, monitoring of the underground electric line installation between the carriage house and the mansion, and the nearby Bartow Cove site (See Figure 2).

During excavations of the carriage house site, nothing was found that could “confidently be assigned to the residents of the estate between c. 1840 and 1888.”(Historical Perspectives, p.62) Excavations of the “path project” also found “no significant stratigraphic levels or in situ cultural resource materials.”(Chrysalis Archaeological Consultants, Inc., p.08) The area had been previously disturbed by past path construction, and was not at a significant depth, 2 feet.

The project area of the septic field was also found to be of “negligible archaeological significance.”(Schuldenrein, p.4) A refuge and burning site was found in the south side of the



leach field and contained a mix of historic bottles and bricks, but the findings were dominated by remains from the 20<sup>th</sup> century.

The monitoring of the electrical utility trench also did not uncover any significant archaeological deposits or features. There were artifacts found under the porch of the mansion, but they could not be related to “a specific historic occupation of the Bartow-Pell Mansion property.”(Louis Berger and Associate, Inc., p.9)

At the Bartow Cove site, located about 300 yards Northeast of the rear of the Bartow Pell Mansion, a dig in 1958 uncovered a shell midden and other Native American artifacts such as arrow heads, bones, and vessel shards. They also found a child’s burial. In 1965, in the same area, Edward J. Kaeser found stone tools. (Kaeser, p.1)

### **Conference House**

The Conference House, Conference House Park, and surrounding are highly archaeologically sensitive. For the purposes of this paper, only areas in the immediate vicinity of the Conference House will be discussed. (For further information on the further areas in the Park, such as the Biddle House, see the reports cited in Figures 3 and 4) From 1979 to 1980; Sharene Baugher, Edward J. Lenik, Robert W. Venables, Kate T. Morgan, and Judith M. Guston all participated in a study of the area. Their investigations in the yards surrounding the Conference House historic artifacts, but also believe that there are possibly prehistoric artifacts in the area as well. The most intact historic deposits were within 5 feet of the house. They believe that the yard on the east side of the building may contain 18<sup>th</sup> century wells, privies, and outbuildings.

### **Dyckman Farmhouse**

Cultural monitoring of infrastructural improvements at the Dyckman Farmhouse in 2007 “no intact, stratigraphic and/or archaeological material cultural level(s) were

uncovered.”(Chrysalis Archaeological Consultants, Inc., p.15) Material remains that were found were disturbed, but it is suggested that future archaeological work may uncover intact findings.

During Linda Stones archaeological testing of the Dyckman Farmhouse Park in 2003, she found a variety of ceramic shards dating from the early 1700’s through the present which she believes to be deposited over time. Despite limited findings, she is also in favor of continued archaeological research in the area.

In the early 20<sup>th</sup> century, Reginold Pelham Bolton conducted early “archaeological” digs in the area surrounding the Dyckman Farmhouse. His study uncovered various artifacts and features (such as Hessian Huts) of the Revolutionary War. The area, which was primarily open land at the time, has since been developed. His findings however, do indicate the archaeological potential of the land that is left intact at the site of the Dyckman Farmhouse.

### **Gracie Mansion**

In the 1980’s, an archaeological investigation took place in the basement, and the surrounding area of Gracie Mansion. The findings included various historic remains which are currently housed at the Mansion. Due to the absence of a final report, all that is known about the excavation is from a series of field notes (For a list of the notes see Figure 1).

### **Historic Richmond Town**

Various archaeological studies and investigations have taken place at Historic Richmond Town which uncovered historical feature and artifact remains. The area remains sensitive.

### **King Manor**

A great deal of archaeological activity has occurred at King Manor, from monitoring to intensive studies. The most recent and detailed analysis is by Christopher Matthews who conducted an archaeological investigation from 2004 to 2006 at King Manor. There were a



wealth of artifacts and features uncovered during this study. King Manor is a highly sensitive area. For details on findings see “Draft Report of 2004-2006 Archaeological Investigations at the Rufus King Manor Site” by Christopher N. Matthews.

### **Kingsland Homestead**

There is a sensitivity report for Weeping Beech Park which notes that the area has a potential for sensitivity, but that 25% of the land has been destroyed due to ground disturbances. The type of remains expected to be found would be from Dutch and English colonial times to the present. The report also includes a map of areas believed to be of high archaeological significance and recommends monitoring of any future development in these areas (Pagano, p.A15).

### **Lott House**

For over a decade the Brooklyn College Archaeological Field School, under the direction of archaeologist H. Arthur Bankoff have been conducting excavations at the Lott House. A wealth of material culture has been discovered ranging from the 17<sup>th</sup> century to the 20<sup>th</sup> century.

### **Merchant’s House Museum**

In the 1990’s three small scale excavations of the Merchant’s House Museum backyard were conducted by the City College of the City University of New York under the direction of archaeologist Diana Wall. During the course of these excavations Wall found various artifacts, the majority of which were historic “architectural artifacts, ceramic sherds, and glass sherds” (Barrett, p. 5-6)

## **Morris-Jumel Mansion**

In 2000, Linda Stone conducted archaeological monitoring of the installation of the fire suppression sprinkler system at the Morris Jumel Mansion. Most of her findings involved trenches consisting of fill, but she noted finding one possible prehistoric artifact that may have been a piece of a tool. She also makes note in her report that previous excavations in Roger Morris Park have uncovered prehistoric remains, and recommends that future excavations occur in the location of the previously excavated trenches (Stone, p.22).

Emergency cultural resource monitoring was done in the park by Alyssa Loorya and Christopher Ricciardi in 2005. They monitored the installation of a new drain pipe in the retaining wall. They did not find anything of significance and believe that monitoring in this specific area is no longer necessary due to its compromised nature due to previous construction on it (Loorya, 7).

In 1994, Arnold Pickman conducted archaeological investigations in reference to a foundation waterproofing project at the Mansion. Pickman's testing and monitoring "indicated the presence of two previously undocumented cobble walkways extending east and west of the "hyphen" portion of the Morris Jumel Mansion" thought to be constructed in the later 19<sup>th</sup> century.(Pickman, p.91) Other architectural artifacts were found, including remains of a flagpole, and fill dating to the period of occupation for the mansion.

In 1986, Susan A. Dublin and Nan Rothschild conducted an archaeological investigation at the Morris-Jumel Mansion. The results of which can be found in "A Report On The Archeological Investigation At The Morris-Jumel Mansion."

## **Queens County Farm Museum**

In 1993, Arnold Pickman conducted an “Archaeological and Historical Study of the Adriance Farm Park.” He identified a cobble path to the immediate south of the farmhouse, determined that much of the area located near the current roadway has been disturbed, found various historical artifacts that date to the pre-Creedmor era, as well as prehistoric artifacts. Due to his findings he believes the area should be studied further.

## **Van Cortlandt Manor**

In 1987 Louis Berger Associates monitored installation of sewage and plumbing lines at the Van Cortlandt Manor. They did not find anything significant in the trenches, and noting that what they did find was displaced.

In the 1990’s the Brooklyn College Archaeological Field School under the direction of archaeologists Drs. H. Arthur Bankoff and Frederick A. Winters conducted various digs at the manor. They found various artifacts that date to the occupation of the house.

## **Wyckoff House**

Since the 1970’s various excavations have occurred at the Wyckoff House both within the basement and the surrounding areas. There have been many cultural remains found ranging in date from the 17<sup>th</sup> century to the present.

## **The Houses**

Many of the houses still have potential archaeological significance with the exclusion of the houses that have been moved from their original locations and specific disturbed areas.

However, many of the disturbed areas could potentially be archaeologically significant if future excavations were deeper. Most of the archaeologists recommend continued study and monitoring of the houses and their surrounding areas, and the author agrees.

## **APPENDIX A**



Figure 1: Master List

House	Title	Document Type	Date	Author	Notes	Location	PDF	to be mapped?	map number
Alice Austen House	Archaeological Investigation	Sensitivity Report	1990	Peter Gisolfi Associates	Includes Maps	HHT Reports: Alice Austen House <i>Historic Landscape Report</i>	yes	no	n/a
Bartow-Pell Mansion	A Brief Note On The Archaeological Resources In Pelham Bay Park	Report	Unknown	Unknown	From Joy Kestenbaum. Part of packet sent to Nancy by Marianne.	HHT House Files: Bartow-Pell Mansion <i>Archaeology</i>	yes	no	n/a
Bartow-Pell Mansion	An Indian Celt Presented to Westchester County Historical Society	Statement	Unknown	Westchester County Historical Society	Part of packet sent to Nancy by Marianne.	HHT House Files: Bartow-Pell Mansion <i>Archaeology</i>	yes	no	n/a
Bartow-Pell Mansion	Archaeological Monitoring Of The Underground Electric Line Installation Between The Carriage House And The Mansion, Bartow-Pell Mansion, The Bronx, New York	Report	November, 1989	The Cultural Resource Louis Berger & Associates, Inc.		HHT House Files: Bartow-Pell Mansion <i>Archaeology</i>	yes	yes	4
Bartow-Pell Mansion	Bartow Cove Site, Pelham Bay Park, Bronx Co., N.Y.	Report	Fall-1965	Edward J. Kaeser	Part of packet sent to Nancy by Marianne.	HHT House Files: Bartow-Pell Mansion <i>Archaeology</i>	yes	yes	5
Bartow-Pell Mansion	Bartow Pell H2O Line Archaeology	Notes	27 March 1991 & 3/22/91	Unknown	Notes on excavation logistics	HHT House Files: Bartow-Pell Mansion <i>Archaeology</i>	yes	no	n/a
Bartow-Pell Mansion	Bartow-Pell Estate Carriage House Site Archaeological Report	Report	10-Sep-85	Historical Perspectives		LPC	yes	yes	1
Bartow-Pell Mansion	Dear Arthur	Letter	27-Jul-93	Nancy Ziegler, Deputy Director, Historic Houses Office	Letter of thanks to Dr. Arthur Bankoff, Brooklyn College Archaeological Field School	HHT House Files: Bartow-Pell Mansion <i>Archaeology</i>	yes	no	n/a
Bartow-Pell Mansion	Dear Bob	Letter	1-Jul-93	Nancy Ziegler, Deputy Director, Historic Houses	Letter of thanks to Bob Bealin, Forest Manager, Van Cortlandt & Pelham Bay Parks.	HHT House Files: Bartow-Pell Mansion <i>Archaeology</i>	yes	no	n/a
Bartow-Pell Mansion	Dear Linda	Letter	1-Jul-93	Nancy Ziegler, Deputy Director, Historic Houses	Letter of thanks to Linda Dockeray, Administrator, Van Cortlandt & Pelham Bay Parks.	HHT House Files: Bartow-Pell Mansion <i>Archaeology</i>	yes	no	n/a
Bartow-Pell Mansion	Dear Lynne	Letter	27-Jul-93	Nancy Ziegler, Deputy Director, Historic Houses Office	Letter of thanks to Lynne Zurcher, President, International Garden Club.	HHT House Files: Bartow-Pell Mansion <i>Archaeology</i>	yes	no	n/a
Bartow-Pell Mansion	Dear Mike	Letter	1-Jul-93	Nancy Ziegler, Deputy Director, Historic Houses	Letter of thanks to Mike Feller, Natural Resources.	HHT House Files: Bartow-Pell Mansion <i>Archaeology</i>	yes	no	n/a
Bartow-Pell Mansion	Dear Ms. Ziegler	Letter	8-May-93	H. Arthur Bankoff, Director, Arcoplex	Letter to Nancy Ziegler, Historic House Trust, in reference to funding.	HHT House Files: Bartow-Pell Mansion <i>Archaeology</i>	no	no	n/a
Bartow-Pell Mansion	Dear Nadia	Letter	27-Jul-93	Nancy Ziegler, Deputy Director, Historic Houses Office	Letter of thanks to Nadia Tscherny, Bartow-Pell Mansion	HHT House Files: Bartow-Pell Mansion <i>Archaeology</i>	yes	no	n/a
Bartow-Pell Mansion	Indian Paths of The Great Metropolis	Book	1922	R.P. Bolton	Include information about early archaeology in the areas surrounding the Bartow Pell Mansion. Pages of relevance 124-128, 236. pg 126-128 discusses rocks off the shore where native american artifacts have been found.	Google Books	yes	no	n/a
Bartow-Pell Mansion	Meeting with Dr. Arthur Bankoff and Fred Winter Bartow-Pell Mansion Museum	Notes	12/12/1992	Unknown		HHT House Files: Bartow-Pell Mansion <i>Archaeology</i>	yes	no	n/a
Bartow-Pell Mansion	Nancy	Various	11/4/1992	Marianne	Note covering packet of texts in reference to Bartow-Pell Archaeology	HHT House Files: Bartow-Pell Mansion <i>Archaeology</i>	yes	no	n/a
Bartow-Pell Mansion	Notes on logistics of an excavation	Notes	Unknown	Unknown		HHT House Files: Bartow-Pell Mansion <i>Archaeology</i>	no	no	n/a
Bartow-Pell Mansion	Phase 18 Cultural Resource Monitoring of the Path Project- Bartow-Pell Mansion, Bronx (Bronx County), New York, Contract Number:X039-108M	Final Report	Oct-08	Alyssa Loorya, Principal Investigator & Christopher Ricciardi	Details Archaeological Work Done in Monitoring Path Replacement. Includes: Description of work, summary & recommendations, site map & photos **Includes Hard & Digital copy	HHT House Files: Bartow-Pell Mansion Museum <i>Pathway OMBP</i>	yes	yes	2
Bartow-Pell Mansion	Preliminary Inventory of Archaeological Resources in Pelham Bay Park	Report	5-Jun-87	Michael J. Feller, Natural Resources Group	Includes Cover Letter. Part of packet sent to Nancy by Marianne.	HHT House Files: Bartow-Pell Mansion <i>Archaeology</i>	yes	no	n/a
Bartow-Pell Mansion	Re: Bartow-Pell Mansion Museum Archaeological Excavation	Letter	Unknown	Nancy Ziegler, Historic and Cultural Properties, City of New York Parks & Recreation	Letter to Coco Taylor, Purchasing and Accounting, City of New York Parks & Recreation requesting bridge tokens for the commute to the site.	HHT House Files: Bartow-Pell Mansion <i>Archaeology</i>	no	no	n/a
Bartow-Pell Mansion	Re: October 8 Meeting	Letter	13-Oct-92	H. Arthur Bankoff	Letter to Mary Ellen Hern in reference to dig.	HHT House Files: Bartow-Pell Mansion <i>Archaeology</i>	yes	no	n/a
Bartow-Pell Mansion	Re: Upcoming Archaeological Excavations at Bartow-Pell Mansion	Letter	2-Jun-93	Nancy Ziegler, Deputy Director, Historic Houses	Letter to Linda Dockeray, Administrator, Van Cortlandt & Pelham Bay Parks.	HHT House Files: Bartow-Pell Mansion <i>Archaeology</i>	yes	no	n/a
Bartow-Pell Mansion	Re: Upcoming Archaeological Excavations at Bartow-Pell Mansion (2)	Letter	31-Mar-93	Nancy Ziegler, Deputy Director, Historic Houses	Letter to Linda Dockeray, Administrator, Van Cortlandt & Pelham Bay Parks. In reference to Brooklyn College Archaeological Field School donating their service for a dig.	HHT House Files: Bartow-Pell Mansion <i>Archaeology</i>	yes	no	n/a
Bartow-Pell Mansion	Summary Report: Archaeological Monitoring Activities Bartow-Pell Mansion Pelham Bay Park Bronx, New York	Summary Report	1-Oct-07	Joseph Schuldenrin, Ph.D	Details Archaeological Work Done in Monitoring the Replacement of a Septic Tank. Includes: Background Research, Sequence of Activities, Results/Interpretations, Maps & Photos	HHT House Files: Bartow-Pell Mansion <i>Archaeology</i>	yes	yes	3
Bartow-Pell Mansion	The Archery Range Site: A preliminary Report	Report	Mar-62	Edward J. Kaeser	Report from New York State Archaeological Association Bulletin No.24. Part of packet sent to Nancy by Marianne.	HHT House Files: Bartow-Pell Mansion <i>Archaeology</i>	yes	no	n/a
Conference House	An Archaeological Investigation: The Conference House Park Site Staten Island, New York	Archaeological Report	Jul-91	Sherene Baugher, Edward J. Lenik, Robert W. Venables, Kate T. Morgan, Judith M. Guston		HHT Reports: Conference House <i>Archaeological Report for Park 1991, Baugher</i>	yes	yes	1
Conference House	Archaeological And Historical Intensive Documentary Research	Report	Nov-97	Arnold Pickman	Extremely detailed report. Includes history of the park during various time periods and ties in archaeological work that has been done/recommends work to be done.	HHT Reports: Conference House <i>Archaeological Documentary Research 1997, Pickman</i>	yes	yes	2
Conference House	Archaeological Investigations: Conference House Park Staten Island, New York	Archaeological Report	2004	Arnold Pickman and Rebecca Yamin with Patrick Heaton, Claudia Milne, Leslie E. Raymer, and Mason Sheffield		HHT Reports: Conference House <i>Park Archeological Investigations 2004, Pickman</i>	yes	yes	4
Conference House	Archaeological Investigations: Conference House Park Staten Island, New York Addendum Report: Biddle House and Wood/Leven House	Report	Feb-05	John Milner Associates, Inc.	Charts and Photos & Filed and Lab Methods for 2004 work	HHT Reports: Conference House <i>Park Archeology Report: Biddle &amp; Wood/Leven 2005, Milner</i>	yes	no	
Conference House	Archaeological Map Pages	Map	1980's	Unknown	Part of a 1980's "Dig" folder	Conference House	yes	yes	5

Figure 1: Master List

Conference House	Blurbs on Types of Artifacts Found	Blurbs	1980's	Unknown	Part of a 1980's "Dig" folder	HHT House Files: Conference House Archaeology	yes	no	
Conference House	Burial Ridge, Archaeology at New York City's Largest Prehistoric Cemetery	Book	1980	Jerome Jacobson	Details archaeology done at Burial Ridge, Nearby to the Conference House	Book @ New York Public Library	yes	no	
Conference House	Conference House Park Cultural Landscape Report	Report	Dec-00	South Street Design Company and Jackson Kihn, Arnold Pickman (Archaeologist)	Includes information on archaeological investigations and sensitivity areas. Includes Addendum, Missing References.	HHT Reports: Conference House Park Cultural Landscape Report 2000, South Street Design	yes	no	
Conference House	Conference House Park Interim Report	Report	June, 1996	South Street Design Company, Jackson & Kihn, Arnold Pickman	Section V discusses Archaeological Preservation Strategy and notes areas of sensitivity, and testing	HHT Reports: Conference House Park Interim Report 1996, South Street Design	yes	no	
Conference House	Conference House Park, Staten Island, New York Archaeological Sensitivity Zones	Report	April, 1988	Arnold Pickman and Rebecca Yamin	Extremely detailed, includes Map	HHT House Files : Conference House Archaeology	yes	no	
Conference House	Conference House Park: Analysis Of Existing Conditions	Report	April 15, 1988 Revised February 15, 1990	Jackson & Kihn and South Street Design Company with James Thorne, Karl Nordstrom, Arnold Pickman, and Rebecca Yamin	Includes information about past excavations of the area, recommendations for future excavations.	HHT Reports: Conference House Condition Report 1990, Jackson	yes	no	
Conference House	Conference House Pavilion To Rise Again	Newspaper Article	Sunday March 29, 1998	Tracey Porpora, Advance South Shore Bureau	Article about the rebuilding of a pavilion by the Conference House, notes that it cannot be built in the park's archaeological zone	HHT Reports: Conference House Park Interim Report 1996, South Street Design	yes	no	
Conference House	Dear Comissioner Gotbaum	Letter	Decemeber 7, 1990	Sydne B. Marshall, Ph.D., PANYC President	Letter in regards to illegal digs at the burial ridge site.	HHT House Files : Conference House Archaeology	yes		
Conference House	Dear Sherene	Letter	23-Oct-84	Paul R. Huey Sr. Scientist/Archaeologist, New York State Office of Parks, Recreation, and Historic Preservation- Bureau of Historic Sites	Letter in reference to stoneware found at the site. Part of a 1980's "Dig" folder.	HHT House Files: Conference House Archaeology	yes	no	
Conference House	Environmental Review	Environmental Review	8/9/1996	LPC	LPC's response to proposed archaeological work in "Conference House Interim Report, June 1996, South Street Design Company.	HHT House Files : Conference House Archaeology	yes	no	
Conference House	Examples of Early English Pottery: Named, Dated, And Inscribed	Selections from Book	1973	John Eliot Hodgkin & Edith Hodgkin	Part of a 1980's "Dig" folder	HHT House Files: Conference House Archaeology	yes	no	
Conference House	Exhibit Catalog/Artifact Worksheet	Exhibit Catalog/Artifact Worksheet	1/11/84-1/17/85	Unknown	Part of a 1980's "Dig" folder	HHT House Files: Conference House Archaeology	no	no	
Conference House	N/A	Letter	25-Aug-76	John P. Carman, Grounds Committee Chairman	Letter to Joseph Bresnan, Director of Historical Parks cc: Malcolm Young about plans for an archaeological dig at the Conference House	HHT House Files : Conference House Archaeology	yes	no	
Conference House	Oakwood Beach water Pollution Control Project Phase 1 Cultural Resources Survey	Report	19-Oct-84	Arnold Pickman & Rebecca Yamin		LPC	yes	no	
Conference House	Oakwood Beach water Pollution Control Project Phase 1 Cultural Resources Survey Appendix	Report	19-Oct-84	Arnold Pickman & Rebecca Yamin		LPC	yes	no	
Conference House	Phase 1B Archaeological Field Testing of CHP-1 and CHP-2	Report	22-Jan-03	Historical Perspectives		LPC	yes	yes	8
Conference House	Phase 1B/2 Archaeological Reconnaissance Survey and Phase 3 Archaeological Mitigations/Monitoring South Richmond Drainage/Conference House Park Watershed	Report	Apr-06	Stuart A Reeve, Cece Saunders, Robert Jacoby, David Gubkin		LPC	yes	yes	7
Conference House	Photograph's of Excavations	Photos	1980's	Unknown	Part of a 1980's "Dig" folder	HHT House Files: Conference House Archaeology	yes	no	
Conference House	Scope of Work Archaeological Reconnaissance Level Field Testing	Report	Dec-97	Arnold Pickman		LPC	yes	no	
Conference House	The Conference House	HSR	April, 1980	Sharene Baugher-Perlin (Archaeologist), Ann M. Beta (Architect), James Dibble (Architectural historian and preservationist), Bill Kushmick (Photographer), Shirley Zavin (Architectural historian and report coordinator)		HHT Reports: Conference House Historic Structure Report 1980, Baugher	yes	no	
Conference House	The Indians of Greater New York and the Lower Hudson	Book	1909	Clark Wissler, Alanson Skinner, James K. Finch, Reginald Pelham Bolton, M. Raymond Harrington, Max Schrabisch, Frank G. Speck	Collection of archaeological work done at various new York sites. Focusing on native american findings.	Google Books	yes	no	
Conference House	Tottenville Staten Island Blocks 7923, 7924, 7925, 7936 Report of Test Excavation	Report	Jan-85	Frederick Winter		LPC	yes	no	9
Dyckman Farmhouse	Bolton Dig Methodology	Report	8/21/2007	NYU Student Project	History of Reginald Pelham Bolton's Archaeology Method circa 1905- approx. 1932	HHT House Files : Dyckman Farmhouse 2007 NYU Student Project	yes	no	
Dyckman Farmhouse	Dyckman Farmhouse Collection Report	Report	Unknown	Rebeca Izquierdo, NYU Graduate Student	Collection Report	HHT House Files : Dyckman Farmhouse 2007 NYU Student Project	yes	no	
Dyckman Farmhouse	Dyckman Images 1 & 2	CD-R Discs	7/24/2007	NYU Student Project	Two Discs of Pictures Taken of Dyckman Artifacts	HHT House Files : Dyckman Farmhouse 2007 NYU Student Project	yes	no	
Dyckman Farmhouse	Military Armament Summary	Report	8/21/2007	NYU Student Project	Military Armament Artifact Summary & Suggestions	HHT House Files : Dyckman Farmhouse 2007 NYU Student Project	yes	no	
Dyckman Farmhouse	N/A	Letter	11-Sep-07	Michele D. Marincola, Sherman Fairchild Chairman and Professor of Conservation	Letter to Lisa Ackerman, Executive Vice President of the Samuel H. Kress Foundation in request financial support to pay students for an extension of the program (Copy)	HHT House Files : Dyckman Farmhouse 2007 NYU Student Project	no	no	
Dyckman Farmhouse	N/A	Letter	30-Apr-08	Thérèse Braddick, Executive Director	Letter of thanks to Max Marmor, President of Samuel H. Kress Foundation cc: Wyman Meers, Michele Marincola, Susan DeVries, for support of graduate students from NYU Conservation Center as they surveyed the Reginald Pelham Bolton archaeological collection at the Dyckman Farmhouse Museum	HHT House Files : Dyckman Farmhouse 2007 NYU Student Project	yes	no	



Figure 1: Master List

Dyckman Farmhouse	N/A	List	Unknown	NYU Student Project	List of Artifacts and where they were found	HHT House Files: Dyckman Farmhouse 2007 NYU Student Project	yes	no	
Dyckman Farmhouse	Phase 1B Cultural Resource Monitoring of the Infrastructural Improvements at the Dyckman Farmhouse Property	Final Report	Dec-07	Alyssa Loorya & Christopher Ricciardi		LPC	yes	yes	1
Dyckman Farmhouse	Recommendations for Display	Recommendations for the treatment of Archaeological Remains	Unknown	NYU Student Project		HHT House Files: Dyckman Farmhouse 2007 NYU Student Project	yes	no	
Dyckman Farmhouse	Relic Room Collection - Dyckman Farmhouse Museum	Table	Unknown	NYU Student Project	Table of Artifacts including their number, category, name, board label, object label, dig site, who discovered them, etc.	HHT House Files: Dyckman Farmhouse 2007 NYU Student Project	yes	no	
Dyckman Farmhouse	Relics of the Revolution	Book	1916	Reginald P. Bolton	Chapter XV: The Hut Camp On The Dyckman Farm. Details Bolton and his associates excavations on the Dyckman Farm in the early 20th century.	Book @ New York Public Library	yes	yes	3
Dyckman Farmhouse	Report on Phase 1A Archaeological Documentary Research And Phase 1B Archaeological Testing Of The Dyckman Farmhouse Museum Park Located at 204th Street And Broadway, (Blocks 2241, Lots 33, 34, 35, and 40), Manhattan, New York	Report	29-Aug-03	Linda Stone		HHT Reports: Dyckman Farmhouse Museum Archaeological Documentary Research 2003, Linda Stone	yes	yes	2
Gracie Mansion	Archaeological Materials	Letter	26-Feb-86	Deborah Krulewitch	Letter to Diane M. Coffey, Joan K. Davidson, Robert Meadows, and Charles Pratt about plans for archaeological exhibit	HHT House Files: Gracie Mansion Archaeology	yes	no	
Gracie Mansion	Archaeological Report	Letters	June 13, August 7, August 23, October 9, 1984 & January 3 1986	Deborah Krulewitch & Ruth O'Brien	Series of 5 letters in regards to Ulana Zakalak's Archaeological Report.	HHT House Files: Gracie Mansion Archaeology	yes	no	
Gracie Mansion	Art Archive Storage List	Key	Unknown	Unknown	List of Artifacts stored at Gracie Mansion Boxes 12-19	HHT House Files: Gracie Mansion Archaeology	yes	no	
Gracie Mansion	Artifact Info Cards	Artifact Info Cards	Unknown	Unknown		Gracie Mansion	yes	no	
Gracie Mansion	Artifact Photos	Photos	8/2/2010	Ashley Bettis	Photos of some of the artifacts stored at Gracie Mansion from the 1980's excavations. Taken with permission from Diana Toole.	N/A	yes	no	
Gracie Mansion	Dear Dr. Jacoby	Letter	17-Aug-84	Edward I Koch	Letter from Koch in reference to historical samples testing.	HHT House Files: Gracie Mansion Archaeology	yes	no	
Gracie Mansion	Dear Evelyn	Letter	February 21, 1986	Deborah Krulewitch	Letter to Evelyn H. Lauder, Corporate Vice President of Estee Lauder Inc. in regards to the exhibit she funded	HHT House Files: Gracie Mansion Archaeology	yes	no	
Gracie Mansion	Dear Mr. Wilkinson	Letter	17-Aug-84	Edward I Koch	Letter from Koch to Associate Conservator at The Metropolitan Museum of Art in reference to the cannonball.	HHT House Files: Gracie Mansion Archaeology	yes	no	
Gracie Mansion	Draft Report On The Archaeological Testing At Gracie Mansion Excavation Of The Areaway Under The East And South Porch	Report	Unknown	Meadows/Woll Architects		HHT House Files: Gracie Mansion Archaeology	yes	no	
Gracie Mansion	East Duct Trench	Notes & Feature Record	2/2/1984, 2/7/1984	Unknown	Includes Maps	HHT House Files: Gracie Mansion Archaeology	yes	yes	1
Gracie Mansion	Excavation Unit Record (Basement East Duct #2)	Excavation Record	4-Feb	Unknown		HHT House Files: Gracie Mansion Archaeology	yes	no	
Gracie Mansion	Excavation Unit Record (NE Trench Unit 2)	Excavation Record	January 30th & 31st 1984	Ingrid Webber & Missy Muendel		Gracie Mansion	yes	no	
Gracie Mansion	Excavation Unit Record (Northeast Trench Unit 1)	Excavation Record	1/30 & 1/31/84	Condell & Grubb		HHT House Files: Gracie Mansion Archaeology	yes	no	
Gracie Mansion	Excavation Unit Record (SE Trench Unit 2)	Excavation Record	1/31 & 2/1, 1984	Unknown		HHT House Files: Gracie Mansion Archaeology	yes	no	
Gracie Mansion	Excavation Unit Record (SW Trench Unit 1)	Excavation Record	2/1-2/2, 1984	Unknown		HHT House Files: Gracie Mansion Archaeology	yes	no	
Gracie Mansion	Excavation Unit Record (SW Trench Unit 2)	Excavation Record	2/1-2/2, 1984	Unknown		HHT House Files: Gracie Mansion Archaeology	yes	no	
Gracie Mansion	Excavation Unit Record (Unit SE 1)	Excavation Record	1/31 - 2/2/84	Unknown	Basement Excavation Record	Gracie Mansion	yes	no	
Gracie Mansion	Film Sheet of Basement Excavations	Film Sheet	Unknown	Unknown		HHT House Files: Gracie Mansion Archaeology	yes	no	
Gracie Mansion	Foundation Wall Photographs	Photos	Unknown	Unknown		Gracie Mansion	yes	no	
Gracie Mansion	Gracie Mansion Archaeological Excavation Inventory of Artifacts	List	Unknown	Unknown		Gracie Mansion	yes	no	
Gracie Mansion	Gracie Mansion: Phase 1 - Porch Reconstruction Report on The Excavation Monitoring (Draft)	Report	Unknown	Robert E. Meadows, P.C., Architects		HHT House Files: Gracie Mansion Archaeology	yes	no	
Gracie Mansion	No Tag in Bag	Note	Unknown	Unknown	Note to Ulana Zakalak about artifacts that needed tags	HHT House Files: Gracie Mansion Archaeology	yes	no	
Gracie Mansion	Northeast Trench Feature 1	Feature Record	Jan 31 & Feb 1 1984	I. Webber & M. Muendel	Includes Maps	HHT House Files: Gracie Mansion Archaeology	yes	no	
Gracie Mansion	Northeast Trench Feature 2	Feature Record	2/6/1984	P. Condell	Includes Maps	HHT House Files: Gracie Mansion Archaeology	yes	no	
Gracie Mansion	Notes	Notes	Unknown	Unknown	Notes on excavations	HHT House Files: Gracie Mansion Archaeology	yes	no	
Gracie Mansion	Photographs from 1980's Excavation & Renovations	Photos	1980's	Ruth M. O'Brien	Contain Notes	HHT House Files: Gracie Mansion Archaeology	yes	no	
Gracie Mansion	Photograph's of Basement Excavations	Photos	February 22nd, March 30, 1984	Herman Bernstien Assoc.		HHT House Files: Gracie Mansion Archaeology	yes	no	
Gracie Mansion	Posthole/Auger Test Record	Posthole/Auger Test Record	3-Feb-84	Robert E. Meadows, P.C. Architect	Test Record for Basement-West Duct	HHT House Files: Gracie Mansion Archaeology	yes	no	
Gracie Mansion	Privy/Well	Notes & Feature Record	March 22 1984	Unknown	Includes Map	HHT House Files: Gracie Mansion Archaeology	yes	no	
Gracie Mansion	Proposal For Continued Archaeological Investigation at Gracie Mansion - Preliminary Draft	Report	Unknown	Unknown		HHT House Files: Gracie Mansion Archaeology	yes	no	
Gracie Mansion	Report on Excavation of the Gracie Mansion porch area (Rough Draft)	Report	Unknown	Unknown		Gracie Mansion	yes	no	
Gracie Mansion	Report Outline	Report	Unknown	Unknown		HHT House Files: Gracie Mansion Archaeology	yes	no	
Gracie Mansion	Rough Draft of Archaeological Report	Report	Unknown	Unknown		Gracie Mansion	yes	no	
Gracie Mansion	Zakalak's Field Book 1	Field Book	Sept. 10, 1981 - 6/9/1983	Ulana D. Zakalak	Field notes including porch excavations	Gracie Mansion	yes	no	

Figure 1: Master List

Gracie Mansion	Zakalak's Filed Book 2	Field Book	January 6, 1984 - February 13, 1984	Zakalak	Field notes from basement excavations at Gracie Mansion	Gracie Mansion	yes	no	
King Manor	Amendment To The Revised Scope Of Work For Archaeological Testing in Advance Of Improvements at Rufus King Park Jamaica, Queens, New York Project Q023-195	Report	8-Mar-97	Linda Stone, Archaeological Consulting	To Joseph LePique, DPR includes May 2nd Amendment, Man hours budget	HHT House Files: King Manor Archaeology	yes	no	n/a
King Manor	Archaeological Sensitivity Model	Report	1984	Jo Ann E. Cotz	Describes archaeological potential for the eleven acre manor and park site. Includes Map, but poor resolution.	HHT Reports: Archaeological Sensitivity Model 1984, Jo Ann E. Cotz	yes	no	n/a
King Manor	Archaeological Tests and Artifact Analysis Results from Rufus King Park, Jamaica, Queens, New York	Report	5-Mar-91	Joel W. Grossman, PhD, Grossman and Associates	Incomplete Draft. Missing pages 12-22, Bibliography, and Appendices A, B, & C	HHT House Files: King Manor Archaeology	yes	no	n/a
King Manor	Archaeologists Delve Into King Manor's Past	Newspaper Article	28-Sep-06	Liz Rhoades	Article from Queens Chronicle	HHT House Files: King Manor Archaeology	yes	no	n/a
King Manor	Archaeologists 'Dig' King Manor and Rufus Park	Newspaper Article	July 22-28, 2005	Michelle Garcia	Article from Press Newspaper	HHT House Files: King Manor Archaeology	yes	no	n/a
King Manor	Archaeology Education Program Teacher's Guide and Program Overview	Manual	2005-06	Community School District 28, NYC Dept. of Education	Guide to an Archaeology Education Program held at King Manor. Includes small general chapter on Previous Archaeological work and findings.	HHT House Files: King Manor Archaeology Education Program	yes	no	n/a
King Manor	Archaeology for Reconstruction of Portions of Rufus King Manor House, #Q023-195	Memorandum	17-Nov-97	John Krawchuk, Preservation Project Manager, Design	To Vincent Alfano, Deputy Director, Queens Construction cc. Oscar Urquiola, Marco Giovannoli, Scott Heyl, Richard Robbins. Includes a copy of the Environmental Review for King Manor	HHT House Files: King Manor Archaeology	yes	no	n/a
King Manor	Bake Oven Excavation At King Manor	Newsletter Article	Fall 2007	Suffolk County Archaeological Association	Article in Suffolk County Archaeological Association's Newsletter	HHT House Files: King Manor Archaeology	yes	no	n/a
King Manor	Change Order for Reconstruction of Portions of Rufus King Manor House, #Q023-195	Memorandum	15-Nov-97	John Krawchuk, Preservation Project Manager, Design	To Vincent Alfano, Deputy Director, Queens Construction cc. Oscar Urquiola, Marco Giovannoli, Scott Heyl, Richard Robbins.	HHT House Files: King Manor Archaeology	yes	no	n/a
King Manor	Digging up history: Students sift artifact at King Manor	Newspaper Article	Monday, August 8, 2005	Louise Wong	Daily News Article	HHT House Files: King Manor Archaeology	yes	no	n/a
King Manor	Draft Report of 2004-2006 Archaeological Investigations at the Rufus King Manor Site	Final Report	Oct-08	Christopher N. Matthews		King Manor	yes	yes	1
King Manor	Environmental Review	Environmental Review	7/30/1997	LPC		HHT House Files: King Manor Archaeology	yes	no	n/a
King Manor	History of King Manor Archaeology	Notes	Unknown	Unknown		HHT House Files: King Manor Archaeology	yes	no	n/a
King Manor	King Manor Archaeological Field School 2005	Newsletter Article	Fall 2005	Suffolk County Archaeological Association	Article in Suffolk County Archaeological Association's Newsletter	HHT House Files: King Manor Archaeology	yes	no	n/a
King Manor	King Manor excavation to reveal how workers lived	Newspaper Article	Thursday, August 4, 2005	Brian Fraga, Times Ledger		HHT House Files: King Manor Archaeology	yes	no	n/a
King Manor	King Manor's Exterior Brick Bake Oven Remnants and Associated Deposits.	Article	Unknown	Jenna Coplin	Article appeared in issue of Suffolk County Archaeological Association's newsletter.	King Manor	yes	no	n/a
King Manor	N/A	Flyer	2005	N/A	Flyer with photos of the field school	HHT House Files: King Manor Archaeology	yes	no	n/a
King Manor	N/A	Letter	4-Aug-97	Linda Stone, Archaeological Consulting	To John Krawchuk, DPR, cc Giovannoli(DPR), LePique (DPR), Levine (Tenalp). Includes summary of archaeological work conducted in 1997	HHT House Files: King Manor Archaeology	yes	no	n/a
King Manor	N/A	Letter	Oct-05	Mary Anne Mrozinski, Executive Director of King Manor Museum	Letter to Therese Braddick, Executive Director of Historic House Trust updating her on the status of Hofstra University's Archaeological Field School at the Manor	HHT House Files: King Manor Archaeology	yes	no	n/a
King Manor	N/A	Transmittal General	6/1/1998	John Krawchuk, Preservation Project Manager	To Daniel Pagano, NYC Landmark's Preservation Commission cc. Mary Anne Mrozinski, Arthur Bankoff, Joseph Lepique, Linda Stone, Scott Heyl. States that a "Report on archaeological testing in advance of improvements associated with the drainage and termite project at [King Park]" was sent by mail for their use.	HHT House Files: King Manor Archaeology	no	no	n/a
King Manor	Oven Photos	Photos	Unknown	Jenna Coplin	Photos that accompany Jenna Coplin's article for SCAA	King Manor	yes	no	n/a
King Manor	Phase 1b Archaeological Survey Report on the Northern Portion of Rufus King Park, Jamaica, Queens County, New York	Report	Feb-90	William t. Roberts IV		LPC	yes	yes	3
King Manor	Re:Rufus King Park	Letter	2-Apr-91	Mary Anne Mrozinski, Executive Director of King Manor Museum	To Queens Borough President Claire Shulman. Includes archaeological results and findings completed by Grossman & Associates.	HHT House Files: King Manor Archaeology	yes	no	n/a
King Manor	Reconstruction of Portions of Rufus King Manor House, #Q023-195	Memorandum	26-Dec-97	John Krawchuk, Preservation Project Manager, Design	To Vincent Alfano, Deputy Director, Queens Construction cc. Oscar Urquiola, Marco Giovannoli, Scott Heyl, Richard Robbins. Includes a copy of Linda Stone's "Scope of Work" for additional archaeological excavations at the manor	HHT House Files: King Manor Archaeology	yes	no	n/a
King Manor	Reconstruction of Portions of Rufus King Manor House, #Q023-195	Memorandum	19-Jun-98	John Krawchuk, Preservation Project Manager, Design	To Vincent Alfano, Director, Queens Construction cc. O. Urquiola, M. Giovannoli, S. Heyl, J. LePique, R. Robbins. Includes a copy of the Environmental Review for King Manor	HHT House Files: King Manor Archaeology	no	no	n/a
King Manor	Report on Archaeological Testing In Advance Of Improvements Associated With The Drainage and Termitte Project At Rufus King Park Jamaica Avenue At 150-153 streets Jamaica Queens, New York Contract #Q023-195 and CNVG 497	Report	1-May-98	Linda Stone		LPC	yes	yes	4
King Manor	Report on Archaeological Testing in Advance of Improvements Associated With The Fence Project At Rufus King Park Jamaica Avenue At 150-153 streets Jamaica Queens, New York Contract #Q023-295	Report	15-Aug-97	Linda Stone		LPC	yes	no	n/a



Figure 1: Master List

King Manor	Revised Scope of Work For Archaeological Testing In Advance Of Improvements At Rufus King Park	Report	27-Aug-96	Linda Stone, Arcaeological Consulting	To Kathryn Bridges (Parks Dept)	HHT House Files: King Manor Archaeology	yes	yes	5
King Manor	Rufus King Park Reconstruction Project - Phase 1B Field Archaeological Monitoring project	Report	Dec-07	Alyssa Loorya & Christopher Ricciardi		LPC	yes	yes	6
King Manor	Scope of Work report for King Manor	Report	7-Aug-97	Linda Stone, Arcaeological Consulting	To Scott P. Heyl. Includes cover letter and Scope of Work report for King Manor	HHT House Files: King Manor Archaeology	yes	yes	2
King Manor	The Archaeology of Captivity and Freedom in Early New York	Magazine Article	Fall 2007	Christopher Matthews and Jenna Coplin	Article in Hofstra Horizons Magazine	HHT House Files: King Manor Archaeology	yes	no	
King Manor	Tree Placement Monitoring	Report	Apr-06	Alyssa Loorya & Christopher Ricciardi		LPC	yes	yes	7
Kingsland Homestead	Archaeological Sensitivity Report Weeping Beech Park	Report	Feb-87	Daniel N. Pagano	Provides assesment of archaeological potential for the park for both precontact period and the historic period, Includes maps, figures, and tables.	HHT Reports: Kingsland Homestead Pre- Design Report for Park 1988, Johansson & Walcavage	yes	no	n/a
Lott House	Archaeology at the Lott House	Report	Unknown	Unknown	Background and general information on archaeology at the Lott House	HHT House Files: Lott House Archaeology	yes	no	n/a
Lott House	Archaeology in Your Backyard!	Flyer	Unknown	Brooklyn College Archaeological Research Center	Introduction to what BC Arch is/does	HHT House Files: Lott House Archaeology	yes	no	n/a
Lott House	Artifact Photos	Photos	5/5/2010	Ashley Bettis	Photos of artifacts found during archaeology by Arthur Bankoff & Brooklyn College at the Lott House	N/A	yes	no	n/a
Lott House	Excavating Brooklyn's Historic Past: The Archaeology of the Hendrick I. Lott House	Report	Unknown	H. Arthur Bankoff, Christopher Ricciardi, and Alyssa Loorya		HHT House Files: Lott House Archaeology	yes	no	n/a
Lott House	General Outline Of The Hendrick I. Lott House Archaeological Component	Report	Wednesday, February 11, 1998	BC ARC		HHT House Files: Lott House Acquisition	yes	no	n/a
Lott House	Lott House	Map	Unknown	BC ARC	Map of the Lott House Land denoting the location of the Garage in proximity to the fence line.	HHT House Files: Lott House Archaeology	yes	no	n/a
Lott House	N/A	Letter	30-Apr-98	H. Arthur Bankoff, Director, Lott House Excavations	Letter to Scott Heyl, HHT, requesting money for supplies for archaeological work to be done at the Lott House.	HHT House Files: Lott House Archaeology	no	no	n/a
Lott House	N/A	Letter	23-Nov-99	Chris Ricciardi	To Scott Heyl, Excutive Director HHT. Letter requesting funding for the year 2000 archaeological excavations at the Lott House.	HHT House Files: Lott House Archaeology	no	no	n/a
Lott House	N/A	Mailer	3-Feb-98	The Hendrick I Lott House Preservation Society, Brooklyn Colege Archaeologists, HHT	Copy of a mailer sent out by the Hendrick I. Lott House Preservation Association to members of the community. Includes Cover Letter by Peggy Accardo to Dorothy Turano District Manager, Community Board 18.	HHT House Files: Lott House Acquisition	yes	no	n/a
Lott House	Not Your Typical New Yorkers: Uncovering Brooklyn's Historic Past at the Hendrick I. Lott House	Magazine Article	Winter 2000	Christopher Ricciardi, Alyssa Loorya, and Dr. H. Arthur Bankoff	Article is on page 15 of <i>This Side Up!</i> Magazine	HHT House Files: Lott House Archaeology	yes	no	n/a
Lott House	Release/Consent Forms	Release/Consent Forms	Summer 1998	Brooklyn College	Release/Consent Forms for students doing archaeological work at the Lott House	HHT House Files: Lott House Archaeology	no	no	n/a
Lott House	The Archaeological Project of the Hendrick I. Lott Farmstead	Report	2000	Brooklyn College Archaeological Research Center	Detailed account of everything dealing with archaeology at the Lott House from 1990-2000. Includes newspaper articles and publicity.	HHT House Files: Lott House Archaeology	yes	no	n/a
Lott House	Untitled	Proposal/Maps	1997	Chris Ricciardi, Department of Anthropology and Archaeology, Brooklyn College	Proposal to let Brooklyn College Archaeological Field School undertake excavations in Marine Park in association with it's link to the Lott family (Hendrick I. Lott House).	HHT House Files: Lott House Archaeology	yes	no	n/a
Merchant's House Museum	Condition Survey of the Archaeological Collections at the Merchant's House Museum	Report	Jul-05	Kerry Barrett, Laura Brill, Alison Clark, Kellie Honeycutt, Lindsay Martin, Mary Oey	Guide to an Archaeology Education Program held at King Manor. Includes small general chapter on Previous Archaeological work and findings.	HHT House Files: Merchant's House History	yes		
Morris-Jumel Mansion	A Report On The Archaeological Investigation At The Morris-Jumel Mansion, Washington Heights, New York City.	Report	1986	Susan A. Dublin with Nan A. Rothschild	Extremely detailed archaeological report. Includes research design & method, transcriptions of historical letters describing the property in the past, Field & Lab Methods, Maps, Analysis, Profile Maps, Descriptions of strata and fill, statistical analysis, HSR, Artifact List.	HHT Reports : Morris Jumel Mansion Restoration Scope of Work 1986, JHPA	yes	yes	4
Morris-Jumel Mansion	Archaeological Investigations Foundation Waterproofing Project Morris Jumel Mansion	Report	1994	Arnold Pickman		LPC	yes	yes	3
Morris-Jumel Mansion	Archaeology Project Completed	Newsletter Excerpt	Unknown	Unknown		HHT House Files: Morris - Jumel Mansion Archaeology	yes	no	n/a
Morris-Jumel Mansion	Re: Morris-Jumel Mansion Scope/Schematics Contract Archaeological Investigation	Letter	26-Mar-86	Richard Pieper, Architectural Conservator, Jan Hird Pokorny - Architects & Planners	Letter to Robert Klien, Dept. of Parks & Rec. Includes Letter from Susan Dublin & Nan Rothschild to Jan Hird Pokorny.	HHT House Files: Morris - Jumel Mansion Archaeology	yes	no	n/a
Morris-Jumel Mansion	Re: Morris-Jumel Scope of Work for Stabilization and Restoration	Letter	5-May-86	Richard Pieper, Architectural Conservator, Jan Hird Pokorny - Architects & Planners	To Robert Klien	HHT House Files: Morris - Jumel Mansion Archaeology	yes	no	n/a
Morris-Jumel Mansion	Report on Archaeological Testing in Advance of Fire Supression Sprinkler Installation at the Morris-Jumel Mansion W 160th Street at Jumel Terrace Manhattan, New York Contract # M073-299	Report	10-Apr-00	Linda Stone		LPC	yes	yes	1
Morris-Jumel Mansion	Roger Morris Park (Morris Jumel Mansion) Emergency Cultural Resource Monitoring Project New York, New York Project #: M073-105M	Report	Mar-05	Alyssa Loorya & Christopher Ricciardi		LPC	yes	yes	2
Morris-Jumel Mansion	Washington Headquarters Association, Inc. Highlights For 1982	Memo	1982	Washington Headquarters Association, Inc.	Notes that "Architectural historical archaeology was done by students of Columbia University [...] as a graduate program field-study project" in 1982.	HHT House Files: Morris - Jumel Mansion Archaeology	yes	no	n/a
Queens County Farm Museum	Adrianse House Artifact Photos	Photos	5/7/2010	Ashley Bettis	Photos of artifacts found during Bert Salwen's 1980's excavations on the Jacob Adrianse Property	N/A	yes	no	n/a



Figure 1: Master List

Queens County Farm Museum	Archaeological And Historical Study Adriance Farm Park	Report	Apr-93	Arnold Pickman	Archaeological report on work that Pickman conducted at the park. Includes documentary research, maps, tables etc. (some figures missing from pdf)	HHT Reports: Queens County Farm Museum <i>Archaeological &amp; Historical Study 1993, Pickman</i>	yes	yes	1
Queens County Farm Museum	Archaeological Investigations at the Jacob Adriance House The Creedmore Property on Little Neck Parkway Contract OMBP 1122	Report	Spring 1985	Louis Berger & Associates		LPC	yes	no	n/a
Queens County Farm Museum	Archaeological Survey of Proposed Utility Lines, Jacob Adriance House, The Creedmore Property on Little Neck Parkway Bellrose, Queens County, New York Contract OMBP 1122	Report	May-85	Louis Berger & Associates		LPC	yes	no	n/a
Queens County Farm Museum	Dear Mr. Trent	Letter	28-Jun-85	Edwin Friedman, Director of Planning & Field Services, Landmark's Preservation Commission	Letter suggesting shovel testing to James Trent, President of Queens County Farm Museum, before construction of workshop began.	HHT House Files: Queens County Farm Museum <i>Archaeology</i>	yes	no	n/a
Queens County Farm Museum	Preliminary Archaeological Testing in The Cellar of the Jacob Adriance House, Bellrose, Queens, New York	Report	Mar-85	Louis Berger & Associates		LPC	yes	no	n/a
Queens County Farm Museum	Queens Co. Farm Museum Jacob Adriance House Slide	Slides	16-May-87	Unknown	Slides of Excavations at the site of the Jacob Adriance House	Queens County Farm Museum	yes	no	n/a
Queens County Farm Museum	Queens County Farm Fall 1983 Excavations	Report	1983	James A. Moore, Warren DeBoer		Queens County Farm Museum	yes	no	n/a
Queens County Farm Museum	Recommendations for Sampling at the Queens County Farm Museum, Site of the Jacob Adriance House	Report	4-May-87	Joanna Kahn		Queens County Farm Museum	yes	no	n/a
Queens County Farm Museum	Report on Spring 1987 Test Excavations At The Jacob Adriance House Site	Report	27-Oct-87	Bert Salwen		LPC	yes	no	n/a
Queens County Farm Museum	Treasurer's Report, etc.	Correspondance, Newspaper Articles, Notes	1992	Nan A. Rothschild, Joan Geismar, Cece Kirkorian		Queens County Farm Museum	yes	no	n/a
Richmond Town	An Archaeological Planning Model Of Richmondtown Restoration Staten Island, New York	Report	Mar-89	Sherene Baugher, Edward J. Lenik, Stephen Barto, Kate Morgan, Dabiel N. Pagano, Robert W. Venables	Includes only Table of Contents and segmented contents divided by house.	HHT House Files: Richmondtown <i>Archaeology</i>	yes		
Richmond Town	Archaeological Field Testing	Report	May-99	Joan H. Geismar		LPC	yes		
Richmond Town	Historic Richmond Town Tysen Court and Center Street Reconstruction Archaeological Sensitivity Assessment	Report	Feb-01	Joan H. Geismar		LPC	yes		
Richmond Town	Report on Phase 1A Archaeological Documentary Research of The Mill Pond Sewer Project Located Along Parts of Old Mill Road, Arthur Kill Road, and Parts of Historic Richmond Town	Report	27-Sep-02	Linda Stone		LPC	yes		
Richmond Town	Report on Phase 1B and 2/3 Archaeological Documentary Research of The Mill Pond Sewer Project Located Along Parts of Old Mill Road, Arthur Kill Road, and Parts of Historic Richmond Town	Report	23-May-03	Linda Stone		LPC	yes		
Richmond Town	Richmondtown Restoration: Comprehensive Site Restoration And Development Plan, Vol 1, 1992	Report	10-Jul-92	Miceli Williams & Associates, Mesick.Cohen.Waite Architects	Archaeological Sensitivity Report. Includes Map. Pg. 3.37-3.40	HHT Reports	yes		
Van Cortlandt	Allowance for Archaeological Investigation	Statement of Purpose	Unknown	Unknown		HHT House Files: Van Cortlandt <i>Archaeology 1of2</i>	yes	no	n/a
Van Cortlandt	Archaeological Dig at Van Cortlandt Park June 1991	Memo	3-Oct-91	Linda Dockeray, Administrator Van Cortlandt/Pelham Bay Parks	To Nancy Zeigler, about meeting with Fred Winter about upcoming dig.	HHT House Files: Van Cortlandt <i>Archaeology 2of2</i>	yes	no	n/a
Van Cortlandt	Archaeological Dig Yields Surprises, Van Cortlandt Park Project Uncovers Indian Artifacts	Newspaper Article	6/27/1991	Eric R. Gerard	Article from Bronx Press Review	HHT House Files: Van Cortlandt <i>Archaeological Newspaper Articles</i>	yes	no	n/a
Van Cortlandt	Archaeological Excavations at Van Cortlandt Park, The Bronx	Report	9-Feb-95	H. Arthur Bankoff, Frederick A. Winter, Christopher Ricciardi	Draft Missing Genealogy tree and site map.	HHT House Files: Van Cortlandt <i>Archaeology 1of 2</i>	yes	no	n/a
Van Cortlandt	Archaeological Excavations at Van Cortlandt Park	Report	1990-1992	H. Arthur Bankoff, Frederick A. Winter, Christopher Ricciardi	Discusses in detail excavations at the house.	LPC/ Draft in HHT House Files: Van Cortlandt <i>Archaeological Reports</i>	yes	no	n/a
Van Cortlandt	Archaeological Testing Of The Proposed Egress Stair And Dry Well Excavation	Report	Aug-85	The Cultural Resource Group Louis Berger & Associates, Inc.	Project # 1016	HHT House Files: Van Cortlandt <i>Archaeological Reports</i>	yes	no	n/a
Van Cortlandt	Archaeology At Van Cortlandt House	Speaking Points	5-Jun-91	Unknown	Presented at Board Meeting	HHT House Files: Van Cortlandt <i>Archaeology 1 of 2</i>	yes	no	n/a
Van Cortlandt	Archaeology Lecture	List of Attendees	2-May-94	Unknown		HHT House Files: Van Cortlandt <i>Archaeology 1of2</i>	yes	no	n/a
Van Cortlandt	Archaeology Photos	Artifact Photos	Unknown	Unknown	Photos of Bottles found	HHT House Files: Van Cortlandt <i>Archaeology 1 of 2</i>	yes	no	n/a
Van Cortlandt	Artifact Bag Catalog	Catalog	Unknown	Louis Berger & Associates		HHT House Files: Van Cortlandt <i>Archaeology 1of2</i>	yes	no	n/a
Van Cortlandt	Brooklyn College Students Uncover History in Van Cortlandt Park	News Bulletin	20-Jun-90	Richard Coniglione, Brooklyn College & Mary Ellen W. Hern, Historic House Trust of New York City		HHT House Files: Van Cortlandt <i>Archaeology 1of2</i>	yes	no	n/a
Van Cortlandt	Brooklyn College Summer Archaeological Field School 1990 Preliminary Report Van Cortlandt Manor Excavations	Report	1990	Brooklyn College Archaeological Research Center		HHT House Files: Van Cortlandt <i>Archaeological Reports</i>	yes	no	n/a
Van Cortlandt	Brooklyn College Summer Archaeological Field School Provisional budget	Budget	Jun-91	Brooklyn College Archaeological Research Center		HHT House Files: Van Cortlandt <i>Archaeology 1of2</i>	no	no	n/a
Van Cortlandt	Brooklyn College Summer Archaeological Field School: 1991 Preliminary Report Van Cortlandt Manor Excavations	Report	1991	Brooklyn College Archaeological Research Center		HHT House Files: Van Cortlandt <i>Archaeological Reports</i>	yes	no	n/a
Van Cortlandt	Brooklyn College Summer Archaeological Field Schools Van Cortlandt Park Excavation 1992 Revised Budget	Budget	Unknown	Unknown		HHT House Files: Van Cortlandt <i>Archaeology 1 of 2</i>	no	no	n/a

Figure 1: Master List

Van Cortlandt	Can you dig it?	Newspaper Article	Unknown	Editorial Comment		HHT House Files: Van Cortlandt Archaeological Newspaper Articles	yes	no	n/a
Van Cortlandt	Dear Arthur	Letter	19-Jan-94	Nancy Ziegler	Letter requesting Arthur Bankoff to be a part of the Historic House Trust lecture series.	HHT House Files: Van Cortlandt Archaeology 2of2	yes	no	n/a
Van Cortlandt	Dear Arthur and Fred	Letter	3-Aug-92	Nancy Zeigler, Historic Houses	Letter of thanks to Drs. Arthur Bankoff and Frederick Winter, Summer Archaeological Field School, Brooklyn College.	HHT House Files: Van Cortlandt Archaeology 2of2	yes	no	n/a
Van Cortlandt	Dear Commissioner Gotbaum	Letter	9-Feb-93	Peter J. Ostrander, Kingsbridge Historical Society	Letter in opposition to proposed location of new tennis courts approved by Gotbaum due to, in part, the archaeological significance of the area.	HHT House Files: Van Cortlandt Archaeology 2of2	yes	no	n/a
Van Cortlandt	Dear Commissioner Gotbaum (2)	Letter	10-Dec-92	Rev. John W. Redic, II, The Bronx Landmarks Task Force	Letter to Commissioner Betsy Gotbaum urging her to move the location of the proposed tennis courts.	HHT House Files: Van Cortlandt Archaeology 2 of 2	yes	no	n/a
Van Cortlandt	Dear Commissioner Gotbaum (3)	Cover Letter and Petition	7-Apr-93	Paul Hecht, Van Cortlandt Tennis Association	Letter and Petition of support for the proposed tennis courts	HHT House Files: Van Cortlandt Archaeology 1 of 2	yes	no	n/a
Van Cortlandt	Dear Commissioner Gotbaum (4)	Letters	8-Feb-93	Thomas Mone, Thomas P. Reilly, & B. Anderson	Letter of opposition to the proposed site of the tennis courts sponsored by the office of Councilwoman June Eiland.	HHT House Files: Van Cortlandt Archaeology 2 of 2	yes	no	n/a
Van Cortlandt	Dear Debbie	Letter	Unknown	Nancy Zeigler, Historic Houses	Letter of thanks to Deborah DeGregorio, Deputy Director, Central Communications, Parks, for the use of walkie-talkies during Van Cortlandt excavations.	HHT House Files: Van Cortlandt Archaeology 2of2	no	no	n/a
Van Cortlandt	Dear Dennis	Letter	23-Aug-93	Elizabeth Betts Leckie, Curator, Historic House Trust of New York City	Letter to Dennis Wentworth, NYSOPRHP, in reference to photographs of wine bottles found during excavations at Cav Cortlandt House.	HHT House Files: Van Cortlandt Archaeology 2of2	yes	no	n/a
Van Cortlandt	Dear Dr. Bankoff	Letter	22-May-90	Avery Anne Lozada	To Arthur Bankoff, chairperson, department of anthropology & archaeology, Brooklyn college. Letter of payment/copy of check	HHT House Files: Van Cortlandt Archaeology 2of2	no	no	n/a
Van Cortlandt	Dear Dr. Bankoff/ Van Cortlandt Park Pipes	Cover Letter and Report	8/31/1993	Diane Dallal, Archaeological Director, New York Uneathed	Report on pipes found during excavations at Van Cortlandt Manor	HHT House Files: Van Cortlandt Archaeological Reports	yes	no	n/a
Van Cortlandt	Dear Dr. Hall	Letter	Unknown	Elizabeth Betts Leckie, Curator, Historic House Trust of New York City	Letter to Dr. Gary Hall, Professor of Pharmacology, in reference to medicine bottles found during excavations at Van Cortlandt House.	HHT House Files: Van Cortlandt Archaeology 2 of 2	yes	no	n/a
Van Cortlandt	Dear Dr. Hess	Letter	11-Dec-89	Mary Ellen w. Hern	Letter to Dr. Robert L. Hess, President of Brooklyn College requesting involvement with the 1990 BC dig at Van Cortlandt.	HHT House Files: Van Cortlandt Archaeology 2of2	yes	no	n/a
Van Cortlandt	Dear Dr. Kufinec	Letter	12-Aug-93	Jean Corrie, Historic House Trust of New York City	Letter to dentist in reference to dentures found during excavations at Van Cortlandt House.	HHT House Files: Van Cortlandt Archaeology 2 of 2	yes	no	n/a
Van Cortlandt	Dear Dr. Swanson	Letter	24-Aug-93	Elizabeth Betts Leckie, Curator, Historic House Trust of New York City	Letter to Dr. Ben Z. Swanson, Jr. of the Dr. Samuel D. Harris National Museum of Dentistry in reference to dentures found during excavations at Van Cortlandt House.	HHT House Files: Van Cortlandt Archaeology 2of2	yes	no	n/a
Van Cortlandt	Dear Drs. Bankoff and Winter	Letter	Unknown	Mary Ellen W. Hern, Executive Director, Historic House Trust & Nancy K. Zeigler, Preservation & Program Ass't, Historic Houses	Letter of thanks for the dig.	HHT House Files: Van Cortlandt Archaeology 2of2	yes	no	n/a
Van Cortlandt	Dear Elizabeth	Letter	August 23rd, 1993	Patricia Mears, Costume and Textiles, Department of Decorative Arts, The Brooklyn Museum	Letter in reference to shoes discovered at the Van Cortlandt House.	HHT House Files: Van Cortlandt Archaeology 2of2	yes	no	n/a
Van Cortlandt	Dear Linda	Letter	26-Jun-92	Mary Ellen W. Hern & Nancy Zeigler	Letter of thanks to Linda Dockeray, Administrator, Van Cortlandt & Pelham Bay Parks for the dig.	HHT House Files: Van Cortlandt Archaeology 2of2	yes	no	n/a
Van Cortlandt	Dear Liz	Bibliography	11-Mar-93	Chris Ricciardi	Running bibliography for Van Cortlandt Park materials and Laboratory Class. Includes Cover Letter.	HHT House Files: Van Cortlandt Archaeology 1of2	yes	no	n/a
Van Cortlandt	Dear Lt. Todd	Letter	Unknown	Nancy Zeigler, Historic Houses	Letter of thanks to Lieutenant Todd for operating the helicopter during the aerial survey of the park.	HHT House Files: Van Cortlandt Archaeology 2of2	yes	no	n/a
Van Cortlandt	Dear Mary Ellen	Letter	7-Jul-93	Pamela Herrick, Director of the Van Cortlandt House	Letter to Mary Ellen W. Hern, Director of the Office of Historic Houses in reference to the return of archaeological materials to the house.	HHT House Files: Van Cortlandt Archaeology 2of2	yes	no	n/a
Van Cortlandt	Dear Mary Ellen (2)	Letter	3-Sep-93	Mimi O'Hagan	Letter to Mary Ellen W. Hern, Executive Director, Historic House Trust in reference to Van Cortlandt dig.	HHT House Files: Van Cortlandt Archaeology 2of2	yes	no	n/a
Van Cortlandt	Dear Mayor Dinkins etc.	Series of Letters	12-Nov-93	Peter J. Ostrander, Kingsbridge Historical Society	Series of letters to various politicians in regards to opposition of proposed tennis courts at Van Cortlandt Park. Letters to: Hon. Mayor David N. Dinkins (Mayor of the City of New York), Hon. Fernando Ferrer (Bronx Borough President), Hon. June M. Eiland (Councilwoman).	HHT House Files: Van Cortlandt Archaeology 2 of 2	yes	no	n/a
Van Cortlandt	Dear Mr. Beard	Letter	26-Oct-92	Mary Ellen W. Hern, Executive Director, Historic House Trust	Request for further funding to Timothy Beard, President, The Order of Colonial Lords of Manors in America.	HHT House Files: Van Cortlandt Archaeology 2of2	yes	no	n/a
Van Cortlandt	Dear Mr. Beard (2)	Letter	20-Sep-91	Mary Ellen W. Hern, Executive Director, Historic House Trust	Letter to Timothy F. Beard, President, The Order of Colonial Lords of Manors in America. Requesting funding for the processing of artifacts from Van Cortlandt.	HHT House Files: Van Cortlandt Archaeology 2of2	yes	no	n/a
Van Cortlandt	Dear Mr. Beard (3)	Letter	24-Mar-92	Mary Ellen W. Hern, Executive Director, Historic House Trust	Letter to Timothy F. Beard, President, The Order of Colonial Lords of Manors in America. Requesting funding for the processing of artifacts from Van Cortlandt.	HHT House Files: Van Cortlandt Archaeology 2of2	yes	no	n/a
Van Cortlandt	Dear Mr. Beard (4)	Letter	28-Sep-93	Mary Ellen W. Hern, Executive Director, Historic House Trust	Update/ request for further funding to Timothy Beard, President, The Order of Colonial Lords of Manors in America	HHT House Files: Van Cortlandt Archaeology 2of2	yes	no	n/a



Figure 1: Master List

Van Cortlandt	Dear Mr. Graham	Letter	19-Sep-91	Mary Ellen W. Hern, Director, Historic & Cultural Properties & Nancy Zeigler, Preservation & Program Assistant, Historic Houses	Letter of thanks to the City Volunteer Corp for back filling the archaeological trenches.	HHT House Files: Van Cortlandt Archaeology 2 of 2	yes	no	n/a
Van Cortlandt	Dear Mr. Huey/Dear Elizabeth	Letters	March 26, 1992 & September 22, 1992	Peter Warnock & Paul R. Huey	Letters in reference to soil samples from Van Cortlandt archaeology	HHT House Files: Van Cortlandt Archaeology 2 of 2	yes	no	n/a
Van Cortlandt	Dear Mr. Kroessler	Letter	12-Mar-92	Mary Ellen W. Hern, Executive Director, Historic House Trust	Letter to Jeffrey Kroessler, The Elliot Willensky Fund, The Municipal Art Society, requesting funding for archaeological dig.	HHT House Files: Van Cortlandt Archaeology 2 of 2	yes	no	n/a
Van Cortlandt	Dear Mr. Murphy	Letter	17-Apr-92	Nancy Zeigler	Letter to Richard Murphy, Operations, Queens. Letter in reference to helicopter request	HHT House Files: Van Cortlandt Archaeology 2 of 2	yes	no	n/a
Van Cortlandt	Dear Mr. Pellizzi	Letter	13-Jul-92	Mary Ellen W. Hern, Executive Director, Historic House Trust	Letter to Francesco Pellizzi, President, Verba Foundation requesting funding for artifact processing.	HHT House Files: Van Cortlandt Archaeology 2 of 2	yes	no	n/a
Van Cortlandt	Dear Mr. Reynolds	Letter	22-Oct-87	John A. Hotopp, Ph.D., Director and Principal Archaeologist, Louis Berger & Associates, Inc.	Letter to Donald M. Reynolds, Curator of Parks, New York City Department of Parks and Recreation	HHT House Files: Van Cortlandt Archaeology 2 of 2	yes	no	n/a
Van Cortlandt	Dear Mrs. O'Hagan	Letter	30-Sep-93	Elizabeth Betts Leckie, Curator, Historic House Trust of New York City	Letter to Mimi O'Hagan in reference to conservation of ceramic artifacts found during excavations at Van Cortlandt.	HHT House Files: Van Cortlandt Archaeology 2 of 2	yes	no	n/a
Van Cortlandt	Dear Ms. Chapin	Letter (Draft)	6-Nov-91	Unknown	Letter to Diana Chapin, Deputy Commissioner for Planning and Capital Projects, New York City Department of Parks in regards to necessary repairs and archaeological monitoring.	HHT House Files: Van Cortlandt Archaeology 2 of 2	yes	no	n/a
Van Cortlandt	Dear Ms. DeCarlo	Letter	14-Jun-85	Ivan M. Lisnitzer, P.E., Chief Engineer, City of New York Parks & Recreation	Letter to Valerie DeCarlo in response to her letter of objection to the cancellation of archaeological fieldwork before work on a new sewer system was put in place. Includes a copy of Valerie DeCarlo's letter.	HHT House Files: Van Cortlandt Archaeology 2 of 2	yes	no	n/a
Van Cortlandt	Dear Ms. Dockeray	Letter	9-Jul-92	Frederick A. Winter, S.O.P.A., Co-Director, Brooklyn College Summer Archaeological Field school	Letter to Linda Dockeray, Administrator, Van Cortlandt & Pelham Bay Parks, c/o N. Ziegler, HHT in regards to archaeological significance of the area of proposed tennis courts	HHT House Files: Van Cortlandt Archaeology 2 of 2	yes	no	n/a
Van Cortlandt	Dear Ms. Hern	Letter	November 24, 1992	Timothy Field Beard, President, 1981- of The Order of Colonial Lords of Manors in America	Letter to Mary Ellen W. Hern, Executive Director, Historic House Trust of New York City, of donation of \$4,000 to be used to analyze and conserve the artifacts from the Van Cortlandt Digs.	HHT House Files: Van Cortlandt Archaeology 2 of 2	yes	no	n/a
Van Cortlandt	Dear Ms. Leckie	Letters	November 12, 1993 & Oct. 1, 1993	Gary D. Hall, Professor of Pharmaceutics, Albany College of Pharmacy & Roy Topka, Research Coordinator, National Bottle Museum	Research/Findings of Medicine Bottles found during excavations at Van Cortlandt House	HHT House Files: Van Cortlandt Archaeology 2 of 2	yes	no	n/a
Van Cortlandt	Dear Ms. Rettig	Letter	12-Aug-93	Jean Corrie, Historic House Trust of New York City	Letter to Jean Rettig, Archivist, Caswell and Massey in regards to identification of a Caswell and Massey bottle found during excavations at the Van Cortlandt House.	HHT House Files: Van Cortlandt Archaeology 2 of 2	yes	no	n/a
Van Cortlandt	Dear Ms. Warfield	Letter	7-Apr-94	Mrs. Paul R. Sloane (Ragna Sloane), Chairman of Van Cortlandt House Museum	Letter to Vivian M. Warfield, Executive Director, Art Commission in support of the proposed tennis courts.	HHT House Files: Van Cortlandt Archaeology 2 of 2	yes	no	n/a
Van Cortlandt	Dear Patricia	Letter	13-Aug-93	Elizabeth Betts Leckie, Curator, Historic House Trust of New York City	Letter to Patricia Mears, Dept. of Decorative arts, Brooklyn Museum. In reference to her interest in shoe fragments discovered during excavations at Van Cortlandt House.	HHT House Files: Van Cortlandt Archaeology 2 of 2	yes	no	n/a
Van Cortlandt	Dear Van Cortlandt Committee Member	Letter	1-Oct-93	Unknown	Letter of invitation to visit the Brooklyn College Archaeology Lab to view the Van Cortlandt House Archaeological Collections	HHT House Files: Van Cortlandt Archaeology 2 of 2	yes	no	n/a
Van Cortlandt	Dear Verba Foundation	Letter	29-May-92	Unknown	Letter (Rough Draft) requesting funding for the Brooklyn College Field School excavations at the house.	HHT House Files: Van Cortlandt Archaeology 2 of 2	no	no	n/a
Van Cortlandt	Did park workmen destroy Van Cortlandt family relics?	Newspaper Article	Thursday, May 23, 1985	Bernard L. Stein	Article from The Riverdale Press	HHT House Files: Van Cortlandt Archaeological Newspaper Articles	yes	no	n/a
Van Cortlandt	Dig may offer glimpse at life in 18th century	Newspaper Article	6/21/1990	Leslie Gaglia	Newspaper article from The Riverdale Press	HHT House Files: Van Cortlandt Archaeological Newspaper Articles	yes	no	n/a
Van Cortlandt	Diggin' the Bronx" Archaeological Excavations at the Van Cortlandt House and Bartow-Pell Mansion	Flyer	1994	Historic House Trust	Flyer of invitation to an evening slide lecture and reception with Dr. H. Arthur Bankoff.	HHT House Files: Van Cortlandt Archaeology 1 of 2	yes	no	n/a
Van Cortlandt	Diggin' the Van Cortlandt House	Newsletter Article	Fall 1990	Julie Mirsberger, Executive Director of Van Cortlandt House Museum		HHT House Files: Van Cortlandt Archaeological Newspaper Articles	yes	no	n/a
Van Cortlandt	Digging Up the Past	Newspaper Article	6/27/1991	Unknown	Article from Bronx Press Review	HHT House Files: Van Cortlandt Archaeological Newspaper Articles	yes	no	n/a
Van Cortlandt	Dirt on Donck	Newspaper Article	Friday, June 22, 1990	John Lewis	Article from Daily News	HHT House Files: Van Cortlandt Archaeological Newspaper Articles	yes	no	n/a
Van Cortlandt	Excavation Notes	Notes	Unknown	Unknown		HHT House Files: Van Cortlandt Archaeology 1 of 2	yes	no	n/a
Van Cortlandt	Exhibition Planning Cover Sheet NYSCA Museum Program-Van Cortlandt House Archaeological Dig Exhibition	Exhibition Planning Sheet	1996	Historic House Trust		HHT House Files: Van Cortlandt Archaeology 1 of 2	yes	no	n/a
Van Cortlandt	For Children	Newspaper Article	6/19/1992	Dulcie Leimbach	Article from New York Times	HHT House Files: Van Cortlandt Archaeological Newspaper Articles	yes	no	n/a
Van Cortlandt	From Private to Public: The Changing Landscape of Van Cortlandt Park; Bronx, New York In The Nineteenth Century	Thesis	Spring 1997	Christopher Ricciardi	Chapter #3 (pp 30-57) discuss archaeology done at Van Cortlandt Park. Includes Photos, Tables, Charts.	HHT Reports	yes	yes	1
Van Cortlandt	From: Van Cortlandt House Museum	Maps	8-Jun-95	Unknown	Map of site & Map of excavations	HHT House Files: Van Cortlandt Archaeology 1 of 2	yes	no	n/a

Figure 1: Master List

Van Cortlandt	Grounds for Battle Indian site in park in dispute	Newspaper Article	Monday March 22, 1993	Steve Schneider	Newspaper article from Newsday	HHT House Files: Van Cortlandt Archaeological Newspaper Articles	yes	no	n/a
Van Cortlandt	Kingsbridge Historical Society v. Department of Parks and Recreation of the City of N.Y.	Supreme Court, New York County (1A Part 22) Case	Monday, January 9, 1995		New York Law Journal Excerpt	HHT House Files: Van Cortlandt Archaeology 1of2	yes	no	n/a
Van Cortlandt	Marked Bottles	Notes	Unknown	Unknown	Notes on marked bottles found during excavations at Van Cortlandt.	HHT House Files: Van Cortlandt Archaeology 1of2	yes	no	n/a
Van Cortlandt	N/A	Contract	9-Jul-96	J. Schuldenrein, GRA	To Laura Correa	HHT House Files: Van Cortlandt Archaeology 1of2	yes	no	n/a
Van Cortlandt	N/A	Correspondance	Summer 2003	Arthur Bankoff, Alyssa Loorya repectively	To Benjamin Haavik at Parks, in regards to Brooklyn College Summer Field School at Van Cortlandt Mills	HHT House Files: Van Cortlandt Archaeology 2 of 2	yes	no	n/a
Van Cortlandt	N/A	Photos (4)	Unknown	Unknown	Photos of the Van Cortlandt House	HHT House Files: Van Cortlandt Archaeology 1of2	no	no	n/a
Van Cortlandt	Objects to be shown for archaeology exhibit	List	Unknown	Unknown		HHT House Files: Van Cortlandt Archaeology 1of2	yes	no	n/a
Van Cortlandt	Phase 1 Archaeological Investigation Of Proposed Sewage/Plumbing Lines And Seepage Basin At Van Cortlandt Mansion	Final Report	Apr-87	The Cultural Resource Group Louis Berger & Associates, Inc.	Final Archaeological Report, includes appendix of artifact findings	HHT House Files: Van Cortlandt Archaeological Reports	yes	yes	2
Van Cortlandt	Phase 1A-1B Archaeological Investigations of the proposed area for the Construction of Six Tennis Courts on the Parade Grounds of Van Cortlandt Park, The Bronx, New York.	Report	Unknown	Nan A. Rothschild, Ph.D. and Christopher N. Matthews, M.A., Department of Anthropology, Columbia University	Missing References and Appedices	HHT House Files: Van Cortlandt Archaeology 1of2	yes	no	n/a
Van Cortlandt	Photo of Wall Believed to be Foundation of Vander Donck's Home	Photo	1913	H.A.C.	Photograh from the collection of the museum of the City of New York	HHT House Files: Van Cortlandt Archaeology 1of2	yes	no	n/a
Van Cortlandt	Picture of earlier home & outbuilding at the Van Cortlandt site	Picture	1844	J.G. Harvey		HHT House Files: Van Cortlandt Archaeology 1of2	yes	no	n/a
Van Cortlandt	Preliminary Statement of Archaeological Sensitivity: Van Cortlandt Mansion and Fencing Perimeter	Report	20-Aug-96	J. Schuldenrein, GRA		HHT House Files: Van Cortlandt Archaeology 1of2	yes	no	n/a
Van Cortlandt	Preserving Van Cortlandt's Heritage	Newspaper Article	Thursday, June 23, 1994	Editorial	The Riverdale Press	HHT House Files: Van Cortlandt Archaeological Newspaper Articles	yes	no	n/a
Van Cortlandt	Re: Archaeologist	Contract	9-Jul-96	Dr. Joseph Schuldenrein	Faxed contract to Laura C. Correa	HHT House Files: Van Cortlandt Archaeology 1of2	yes	no	n/a
Van Cortlandt	Re: CCF Account Zoo 21/ Historic House Trust	Memo	9-May-90	Mary Ellen Hern	Memo to Kevin Green authorizing partial payment to Brooklyn College for archaeological dig at house.	HHT House Files: Van Cortlandt Archaeology 2of2	no	no	n/a
Van Cortlandt	Re: Excavations and archaeological tests on the site of the proposed tennis courts at Van Cortlandt Park	Letter	1-May-93	H.A. Bankoff, Director, Brooklyn College Summer Archaeological Field School	Letter to L. Dockery, NYC Department of Parks and Recreation discussing test excavations yielding nothing of significance and giving the ok for the construction of the tennis courts.	HHT House Files: Van Cortlandt Archaeology 2 of 2	yes	no	n/a
Van Cortlandt	RE: Helicopter Request for Van Cortlandt Park Survey	Memo	29-Jan-92	Mary Ellen W. Hern, Director, Historic & Cultural Properties & Nancy Zeigler, Preservation Assistant, Historic Houses	To A/C Ed Norris, Citywide Services	HHT House Files: Van Cortlandt Archaeology 2of2	yes	no	n/a
Van Cortlandt	RE: Request for Walkie-Talkies	Memo	21-Dec-92	Nancy Zeigler, Deputy Director, Historic Houses	To Debbie DeGregorio, Deputy Director, Central Communications	HHT House Files: Van Cortlandt Archaeology 2of2	yes	no	n/a
Van Cortlandt	RE: Van Cortlandt Archaeology Preparation	Letter	22-Apr-92	Nancy Zeigler, Historic Houses	To Linda Dockera, Van Cortlandt Park Administrator	HHT House Files: Van Cortlandt Archaeology 2of2	yes	no	n/a
Van Cortlandt	Re: Van Cortlandt Archaeology Project	Memo	25-Aug-92	Elizabeth Leckie, HHT	Letter to schedule a meeting with Fred Winter & Arthur Bankoff	HHT House Files: Van Cortlandt Archaeology 2of2	no	no	n/a
Van Cortlandt	RE: Van Cortlandt Archaeology Requests	Letter	22-Apr-92	Nancy Zeigler	To Don DeFillo	HHT House Files: Van Cortlandt Archaeology 2of2	yes	no	n/a
Van Cortlandt	Re: Van Cortlandt Archaeology/Backhoe Request	Letter	8-Jun-90	Mary Ellen W. Hern, Director, Historic Houses, City of New York Parks & Recreation	Letter to George Tactikos, Chief, Technical Services. Requesting a backhoe for Brooklyn Colleges Archaeological Field School at the house.	HHT House Files: Van Cortlandt Archaeology 2of2	yes	no	n/a
Van Cortlandt	RE: Van Cortlandt Helicopter Situation	Memo	23-Apr-92	Nancy Zeigler	To Mary Ellen W. Hern	HHT House Files: Van Cortlandt Archaeology 2of2	yes	no	n/a
Van Cortlandt	Re: Van Cortlandt House Archaeological Dig	Letter	20-Jun-90	Mary Ellen W. Hern, Director, Historic Houses, City of New York Parks & Recreation and Paul Berizzi, Administrator, Van Cortlandt/Pelham Bay Parks	Letter to Commissioner Betsy Gotbaum inviting her to come visit the house to see the Brooklyn College Field School's dig.	HHT House Files: Van Cortlandt Archaeology 2of2	yes	no	n/a
Van Cortlandt	Re: Van Cortlandt Park Archaeology	Letter	7-Jan-92	Historic House Office of City of New York Parks & Recreation	Letter to "All Concerned" about the, then, upcoming archaeological excavations at Van Cortlandt	HHT House Files: Van Cortlandt Archaeology 2of2	yes	no	n/a
Van Cortlandt	Re: Van Cortlandt Park Helicopter Request	Memo	24-Feb-92	Nancy Zeigler, Historic Houses	To Richard Murphy, Chief of Operations, Queens., Includes Map.	HHT House Files: Van Cortlandt Archaeology 2of2	yes	no	n/a
Van Cortlandt	RE: Van Cortlandt Park Helicopter Survey	Memo	12-Mar-92	Nancy Zeigler, Preservation/Program Ass't, Historic Houses	To Linda Dockera, Van Cortlandt Park Administrator	HHT House Files: Van Cortlandt Archaeology 2of2	yes	no	n/a
Van Cortlandt	RE: Walkie-Talkie Request for Van Cortlandt Park Archaeology	Memo	13-Mar-92	Nancy Zeigler, Preservation Ass't, Historic Houses	To Deborah DeGregorio, Deputy Director, Communications	HHT House Files: Van Cortlandt Archaeology 2of2	yes	no	n/a
Van Cortlandt	Technical Proposal for Limited Phase 1 Archaeological Investigations at the Van Cortlandt Museum, Bronx, N.Y.	Report	7/10/1996	J. Schuldenrein, GRA		HHT House Files: Van Cortlandt Archaeology 1 of 2	yes	no	n/a
Van Cortlandt	These walls can talk & Archaeologists reveal life of the Van Cortlandts	Newspaper Articles	Thursday, May 7, 1992	Leslie Gaglia	Articles from The Riverdale Press, Section B, Better Living	HHT House Files: Van Cortlandt Archaeological Newspaper Articles	yes	no	n/a
Van Cortlandt	Untitled	Letter	Unknown	Unknown	Letter (Draft) to the Wenner-Gren Foundation requesting funding for artifact processing.	HHT House Files: Van Cortlandt Archaeology 2of2	yes	no	n/a
Van Cortlandt	Untitled (2)	Memo	Unknown	Unknown	Memo announcing slide lecture "Digging the Past: Archaeology at the Van Cortlandt House and Park" by Arthur Bankoff & Frederick Winter	HHT House Files: Van Cortlandt Archaeology 2of2	yes	no	n/a
Van Cortlandt	Untitled (3)	Memo	12-Jun-91	Unknown	Memo inviting all interested to come observe Van Cortlandt dig in progress.	HHT House Files: Van Cortlandt Archaeology 2of2	yes	no	n/a
Van Cortlandt	Van Cortlandt Archaeology Slides	Slides	Unknown	Unknown	Slides of excavations & artifacts	HHT House Files: Van Cortlandt Archaeology 1 of 2	yes	no	n/a
Van Cortlandt	Van Cortlandt Artifacts	Notes	15-Jul	Unknown		HHT House Files: Van Cortlandt Archaeology 1of2	yes	no	n/a



Figure 1: Master List

Van Cortlandt	Van Cortlandt House Archaeology	Newletter Article	Winter/Spring 1992	Unknown	Article from "View From The Top" page 7	HHT House Files: Van Cortlandt Archaeological Newspaper Articles	yes	no	n/a
Van Cortlandt	Van Cortlandt House Archaeology Meeting	Notes	21-Sep-93	Unknown		HHT House Files: Van Cortlandt Archaeology 1of2	yes	no	n/a
Van Cortlandt	Van Cortlandt House Excavations	Report	1990 & 1991	H. Arthur Bankoff, Frederick A. Winter, Brooklyn College CUNY	Report on excavations carried out	HHT House Files: Van Cortlandt Archaeological Reports	yes	no	n/a
Van Cortlandt	Van Cortlandt Mansion Excavations Brooklyn College Summer Archaeological Field School	Statement	Unknown	Unknown	Project Summary	HHT House Files: Van Cortlandt Archaeology 1 of 2	yes	no	n/a
Van Cortlandt	Van Cortlandt Park	Letter	15-Jun-90	George Tactikos, City of New York Parks & Recreation	Letter to Mary Ellen Hern in reference to her request for a backhoe for the Brooklyn College excavations at the house.	HHT House Files: Van Cortlandt Archaeology 2of2	yes	no	n/a
Van Cortlandt	Wenner Gren	Letter	Unknown	Unknown	Letter (Draft) requesting funding for the processing of artifacts uncovered at the Van Cortlandt house.	HHT House Files: Van Cortlandt Archaeology 2of2	yes	no	n/a
Wyckoff House	A Wayward Canarsie Lane Discovered At Wyckoff In Archaeological Dig	Newspaper Article	6-Jul-95	Unknown	Article from Canarsie Courier	HHT House Files: Wyckoff House Archaeology	yes	no	n/a
Wyckoff House	An Archaeological Reconnaissance at the Pieter Claesen Wyckoff House	Report	1973	Bert Salwen, Sarah Bridges, and Joel Klein	Details archaeological reconnaissance in connection with architectural study.	LPC	yes	yes	1
Wyckoff House	An Archaeological Reconnaissance at the Pieter Claesen Wyckoff House (B)	Report	Jul-74	Bert Salwen, NYSAAF, Sarah Bridges, and Joel Klein	Edited version of report as printed in the New York State Archaeological Association Bulletin Number 61	HHT House Files: Wyckoff House Archaeology	yes	no	n/a
Wyckoff House	Historic Wyckoff House	Newspaper Article	20-Jun-96	Kathleen Woods	Article from Canarsie Courier pg.5	HHT House Files: Wyckoff House Archaeology	yes	no	n/a
Wyckoff House	Archaeological Impact of the Pieter Claesen Wyckoff House Barn Construction	Letter	24-Sep-04	Amanda Sutphin, Director of Archaeology, LPC	To Therese Braddick, Executive Director, HHT. Letter discussing archaeological monitoring and involvement at the Wyckoff House during Barn construction. References Arthur Bankoff and Alyssa Loorya's involvement.	HHT House Files: Wyckoff House Archaeology	yes	no	n/a
Wyckoff House	Brooklyn College Archaeological Field School To Excavate At Pieter Claesen Wyckoff House	Newspaper Article	Thursday , April 7, 1994	Benjamin Schmerler	Article from The Daily Plant Volume IX, Number 68	HHT House Files: Wyckoff House Archaeology	yes	no	n/a
Wyckoff House	Dear Mr. Beard	Letter	18-Mar-94	Mary Ellen W. Hern, Executive Director, Historic House Trust	Letter to Timothy Beard, President, The Order of Colonial Lords of Manors in America, thanking him for a donation and inviting him for a tour of the work being done at Wyckoff.	HHT House Files: Wyckoff House Archaeology	yes	no	n/a
Wyckoff House	Dear Mr. Bianchi	Letter	18-Jun-92	Andrea Reynolds, Deputy Director HHT	Letter to Leonard Bianchi, Labs Director, New York University requesting artifacts be returned to Wyckoff House.	HHT House Files: Wyckoff House Archaeology	yes	no	n/a
Wyckoff House	Dear Mr. Hurley	Letter	30-Jul-92	Andrea Reynolds, Deputy Director HHT	Letter to James P. Hurley	HHT House Files: Wyckoff House Archaeology	yes	no	n/a
Wyckoff House	Dear Mr. Steenhuisen	Letter	10-Jul-92	Andrea Reynolds, Deputy Director HHT	Letter to Allan H. Steenhuisen, John Milner Associates	HHT House Files: Wyckoff House Archaeology	yes	no	n/a
Wyckoff House	Dear Valerie	Letter	31-May-96	H. Arthur Bankoff	Letter requesting funds from Valerie Kalas, HHT, for Brooklyn College Field School excavations at the house	HHT House Files: Wyckoff House Archaeology	no	no	n/a
Wyckoff House	Historic House Trust Sails Into Summer Season With New Brochure & Archaeological Excavation	Newsletter Article	Friday, June 16, 1995	Unknown	Article from The Daily Plant Volume X, Number 1904	HHT House Files: Wyckoff House Archaeology	yes	no	n/a
Wyckoff House	Historic Structure Report of the Pieter Claesen Wyckoff House Brooklyn, New York	Report	Nov-79	John Milner Associates	Archaeological Analysis, Excavation, & Summary. Archaeological Recommendations. Includes diagrams/plans of test units. DRAFT	HHT Reports	yes	yes	2
Wyckoff House	N/A	Letter	1-Sep-92	Jim Hurley	To Nancy Ziegler, HHT. Letter in regards to Bert Salwen's archaeological report on the Wyckoff House (1972)	HHT House Files: Wyckoff House Archaeology	yes	no	n/a
Wyckoff House	Phase 1 B Cultural Resource Monitoring of the Landscape project - Pieter Claesen Wyckoff House, Brooklyn (Kings County), New York, Contract Number : B376-102M-A1.	Report	2004	Alyssa Loorya, Principal Investigator & Christopher Ricciardi	Summary of work overseeing landscape project. DRAFT	HHT Reports Archaeology Report DRAFT 2004, Loorya/Ricciardi	yes	yes	3
Wyckoff House	Phase 1B Cultural Resource Monitoring of the Landscape Project	Report	Nov-04	Alyssa Loorya & Christopher Ricciardi		LPC	yes	no	n/a
Wyckoff House	Pieter Claesen Wyckoff House Museum Archaeology Project	Report	12-Aug-92	Andrea Reynolds, Deputy Director HHT	Report on all archaeological work done at the Wyckoff House before 1992. Includes Recommendations for future work, pictures, and maps.	HHT House Files: Wyckoff House Archaeology	yes	yes	4
Wyckoff House	Plan Of Excavated Units Wyckoff House	Map	Unknown	John Milner Associates	Figure 1	HHT House Files: Wyckoff House Archaeology	yes	no	n/a
Wyckoff House	Plan Showing Areas Of Disturbance At The Conclusion Of The 1981-1982 Archaeological Investigations	Map	1982	John Milner Associates	Figure 2	HHT House Files: Wyckoff House Archaeology	yes	no	n/a
Wyckoff House	Re: Archaeological Base Map Pieter Claesen Wyckoff House	Letter	10-Jun-92	Allan H. Steenhuisen, President, John Milner Associates	Letter to Andrea Reynolds	HHT House Files: Wyckoff House Archaeology	yes	no	n/a
Wyckoff House	RE: Permission to Conduct Archaeological Excavations at the Pieter Claesen Wyckoff House	Letter	22-Feb-94	Mary Ellen W. Hern, Director, Art & Antiquities & Nancy Ziegler, Deputy Director, Historic Houses	Letter to Brooklyn Borough Commissioner Julius Spiegel	HHT House Files: Wyckoff House Archaeology	yes	no	n/a
Wyckoff House	RE: Upcoming Archaeological Excavations at Wyckoff House	Memo	4-May-94	Nancy Zeigler, Deputy Director, Historic Houses	Letter to all concerned regarding a preliminary meeting	HHT House Files: Wyckoff House Archaeology	yes	no	n/a
Wyckoff House	RE: Wyckoff House Excavation	Memo	30-Mar-94	Julius Spiegel	Letter to Mary Ellen W. Hern giving permission for excavations	HHT House Files: Wyckoff House Archaeology	yes	no	n/a
Wyckoff House	Second Session Of Archaeological Excavations Takes Place At Wyckoff House	Memo	Tuesday, June 20, 1995	Unknown		HHT House Files: Wyckoff House Archaeology	yes	no	n/a
Wyckoff House	The History and Archaeology of the Wyckoff Homestead	Report	Sep-97	H. Arthur Bankoff, Christopher Ricciardi and Alyssa Loorya	Summary of archaeology conducted by the Brooklyn College Field School from June 1994 - June 1996. Includes History, Analysis, Photos, Trench Map, and Profile Maps	HHT Reports	yes	yes	5
Wyckoff House	Third Session Of Excavations Begins At Historic Wyckoff House	Newsletter Article	Friday, June 14, 1996	Valerie Kalas, Special Projects, HHT	Article from The Daily Plant Volume XI, Number 2149	HHT House Files: Wyckoff House Archaeology	yes	no	n/a
Wyckoff House	Wyckoff House	Map	Unknown	Unknown		HHT House Files: Wyckoff House Archaeology	yes	no	n/a



Figure 1: Master List

Wyckoff House	Wyckoff House Archaeology	Memo	31-May-96	Valerie Kalas, Special Projects, HHT	Sent to Brooklyn Borough Commissioner Julius Spiegel, Alan Miller- APRM Distric 17, Phil Rabena - PPS Distric 17, John Fiorvante - PS Distric 17 respectively.	HHT House Files: Wyckoff House Archaeology	yes	no	n/a
Wyckoff House	Wyckoff House Archaeology (2)	Notes	Unknown	Unknown		HHT House Files: Wyckoff House Archaeology	yes	no	n/a
Wyckoff House	Wyckoff House Archaeology (3)	Letter	9-Jun-95	Valerie Kalas, Special Projects, HHT	Letter to Steve Andors, APRM informing him that Valerie is taking over for Nancy Ziegler as projects coordinator for archaeology at the houses	HHT House Files: Wyckoff House Archaeology	yes	no	n/a
Wyckoff House	Wyckoff House Archaeology (4)	Letter	July, 18 1995	Valerie Kalas, Special Projects, HHT	Letter to Steve Andors, APRM	HHT House Files: Wyckoff House Archaeology	yes	no	n/a
Wyckoff House	Wyckoff House Archaeology (5)	Letter	July, 18 1995	Valerie Kalas, Special Projects, HHT	Letter to Borough Commissioner Julius Spiegel	HHT House Files: Wyckoff House Archaeology	yes	no	n/a
Wyckoff House	Wyckoff House Artifacts	Letter	20-Jul-92	Andrea Reynolds	Letter to File noting the transfer of artifacts from the parks dept. to the Wyckoff House. The artifacts were unearthed in 1972 during archaeological testing by Dr. Bert Salwen of NYU.	HHT House Files: Wyckoff House Collections - Archaeological	yes	no	n/a
Wyckoff House	Wyckoff House Dig	Blurb	Unknown	Unknown		HHT House Files: Wyckoff House Archaeology	yes	no	n/a
Wyckoff House	Wyckoff House Excavations Photos	Photos	1981	Unknown		HHT House Files: Wyckoff House Archaeology	yes	no	n/a
Wyckoff House	Wyckoff Project Proposal	Memo	13-May-92	Donald DeFillo	To Mary Ellen Hern	HHT House Files: Wyckoff House Archaeology	yes	no	n/a

# Bartow-Pell Mansion Archaeological Excavations Map

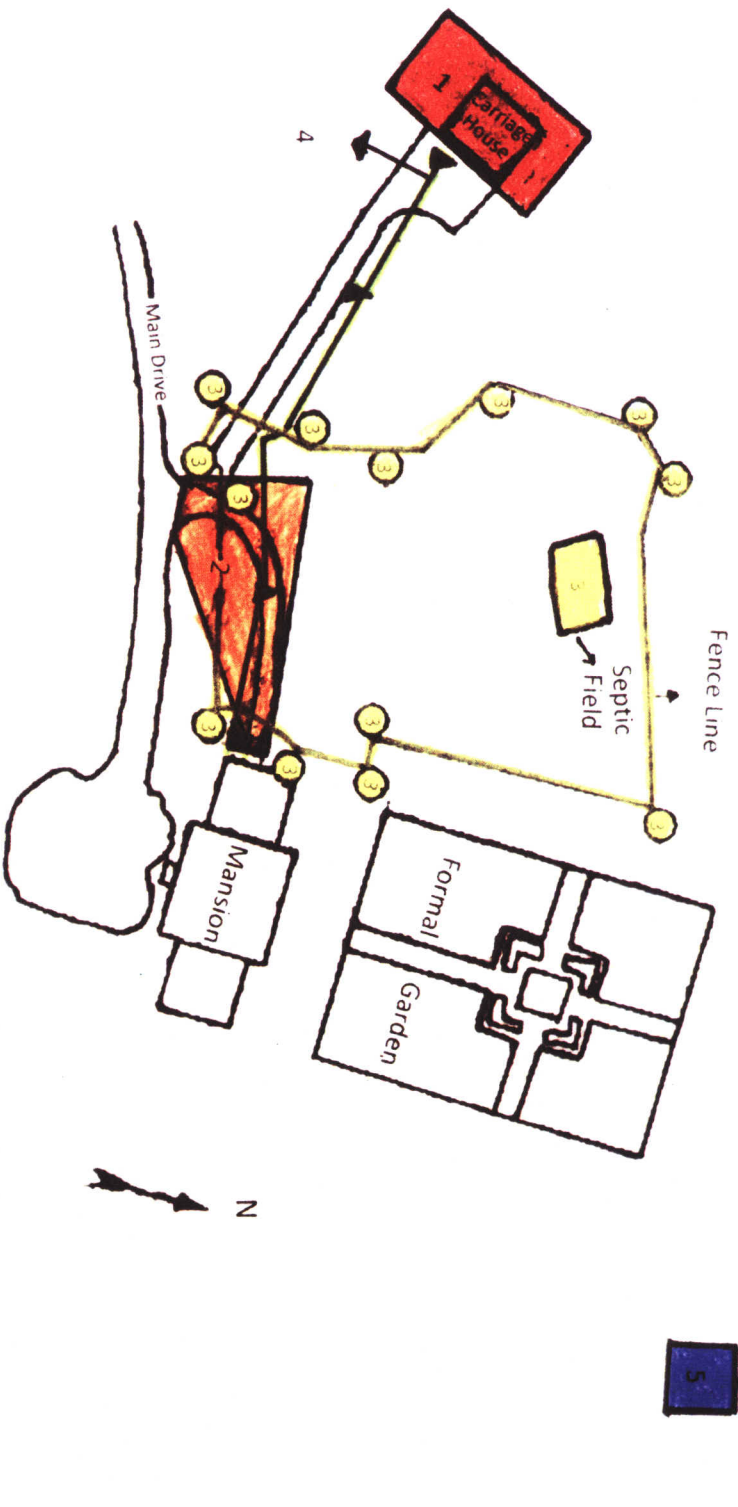

Figure 2: Bartow-Pell Mansion Archaeological Excavations Map (Rough Draft)

Key:

- 1 - Bartow-Pell Estate Carriage House Site Archaeological Report, 1985
- 2 - Phase 1B Cultural Resource Monitoring of the Path Project- Bartow-Pell Mansion, Bronx (Bronx County), New York, Contract Number: X039-108M, 2008
- 3 - Summary Report: Archaeological Monitoring Activities Bartow-Pell Mansion Pelham Bay Park Bronx, New York, 2007
- 4 - Archaeological Monitoring Of The Underground Electric Line Installation Between The Carriage House And The Mansion, Bartow-Pell Mansion, The Bronx, New York, 1989
- 5 - Bartow Cove Site, Pelham Bay Park, Bronx Co. N.Y., 1965

- Not to Scale. Based on a map by Chrysalis Archaeological consultants, Inc 2008.

# Conference House Archaeological Excavations Map 1 of 2

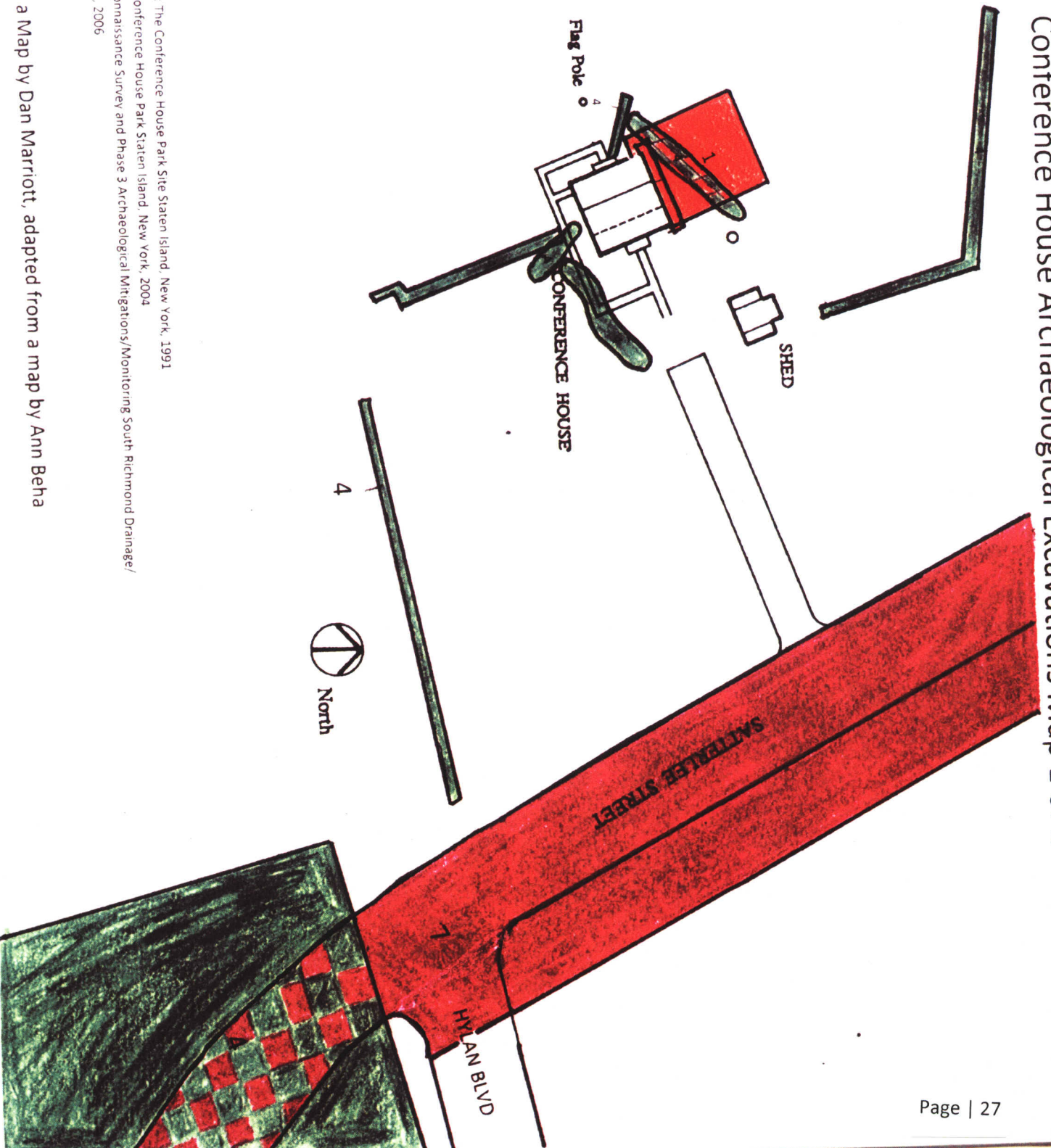

Figure 3: Conference House Archaeological Excavations Map 1 of 2 (Rough Draft)

- Key
- An Archaeological Investigation: The Conference House Park Site Staten Island, New York, 1991
  - 4 Archaeological Investigations: Conference House Park Staten Island, New York, 2004
  - Phase 1B/2 Archaeological Reconnaissance Survey and Phase 3 Archaeological Mitigations/Monitoring South Richmond Drainage/Conference House Park Watershed, 2006

- Not to Scale. Based on a Map by Dan Marriott, adapted from a map by Ann Beha



Figure 4: Conference House Archaeological Excavations Map 2 of 2 (Rough Draft)

# Conference House Archaeological Excavations Map 2 of 2

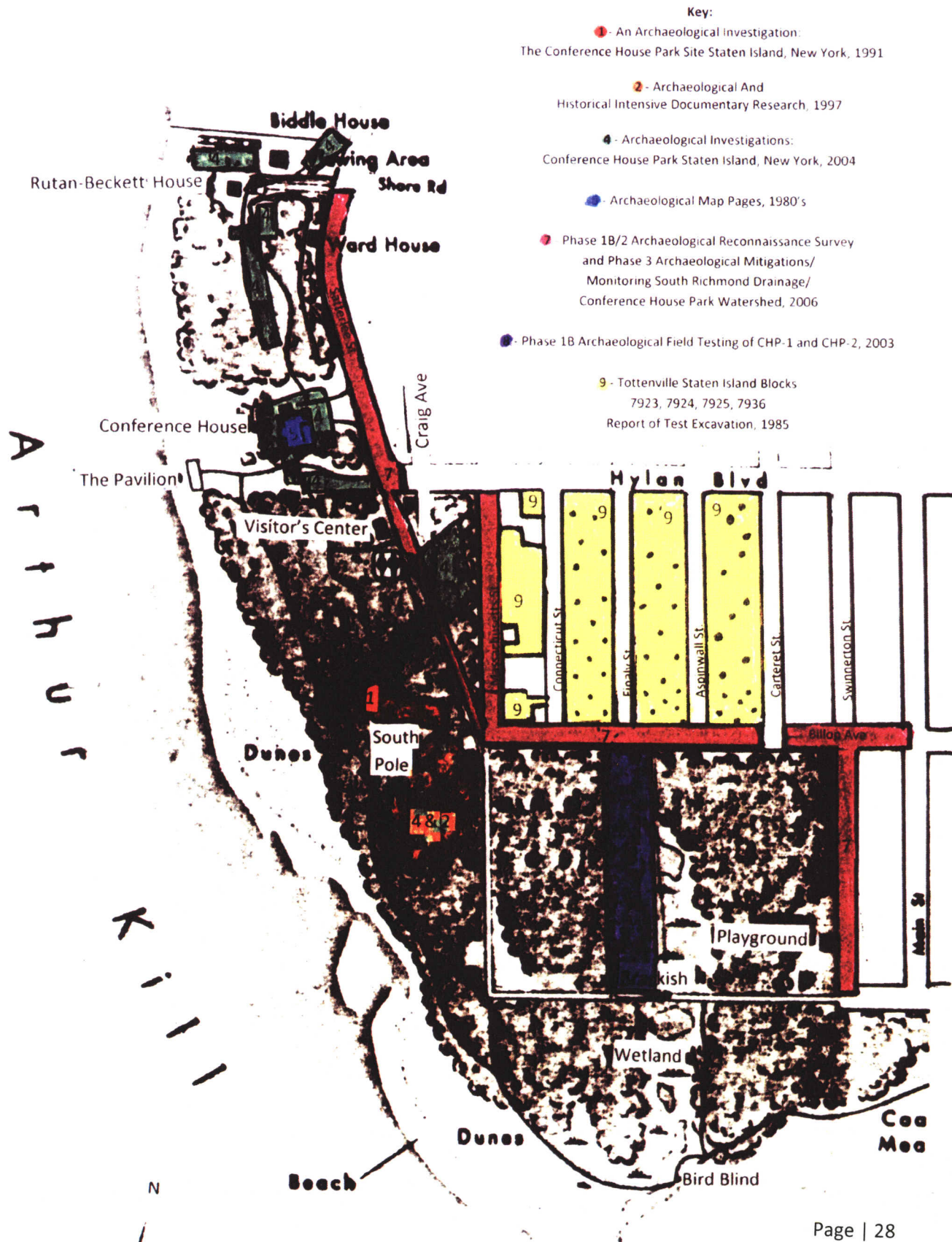
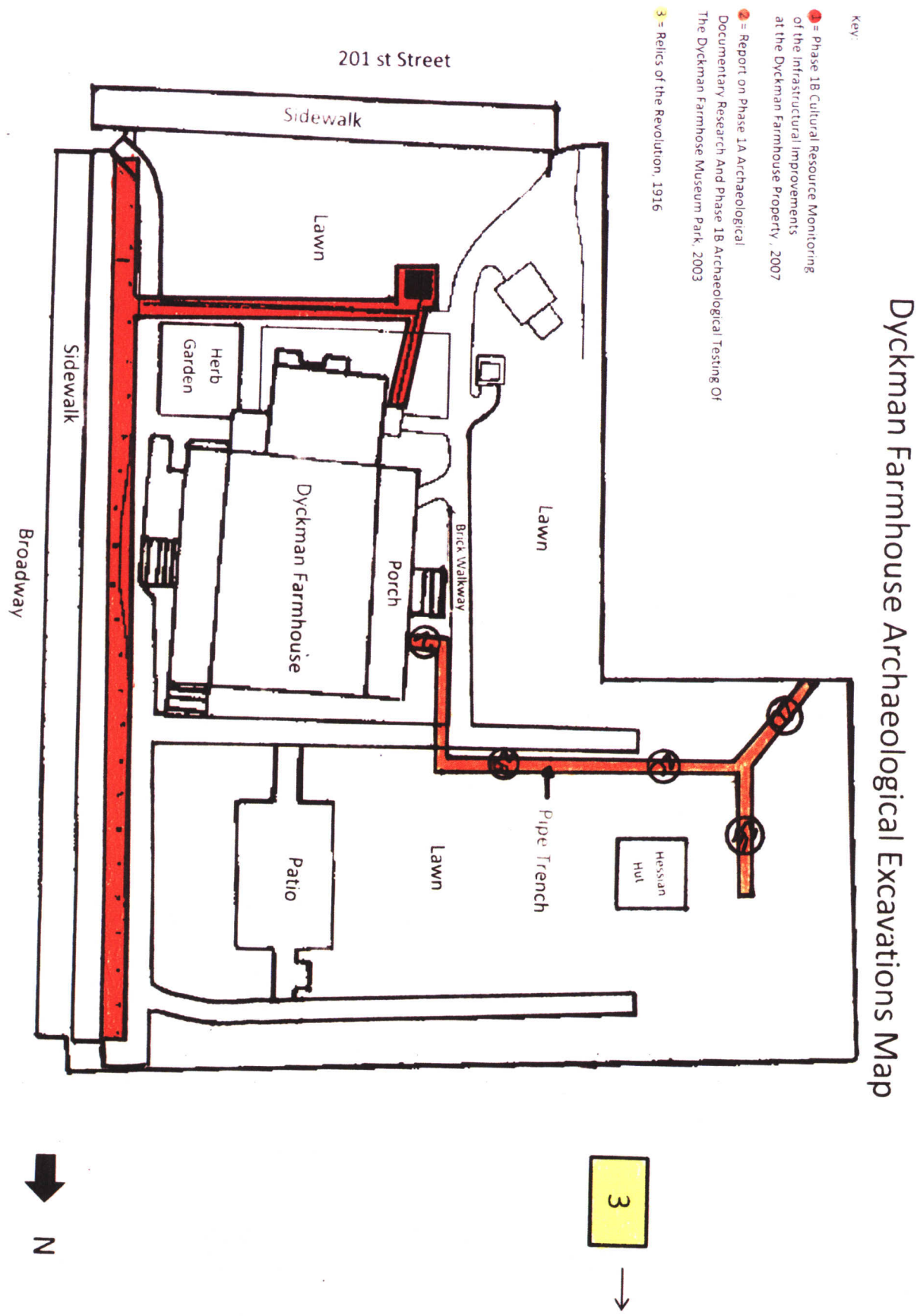



Figure 5: Dyckman Farmhouse Archaeological Excavations Map (Rough Draft)



• Not to scale. Based on a map by Chrysalis Archaeological Consultants, Inc. 2007

Figure 6: Gracie Mansion Archaeological Excavations Map (Rough Draft)

## Gracie Mansion Archaeological Excavations Map

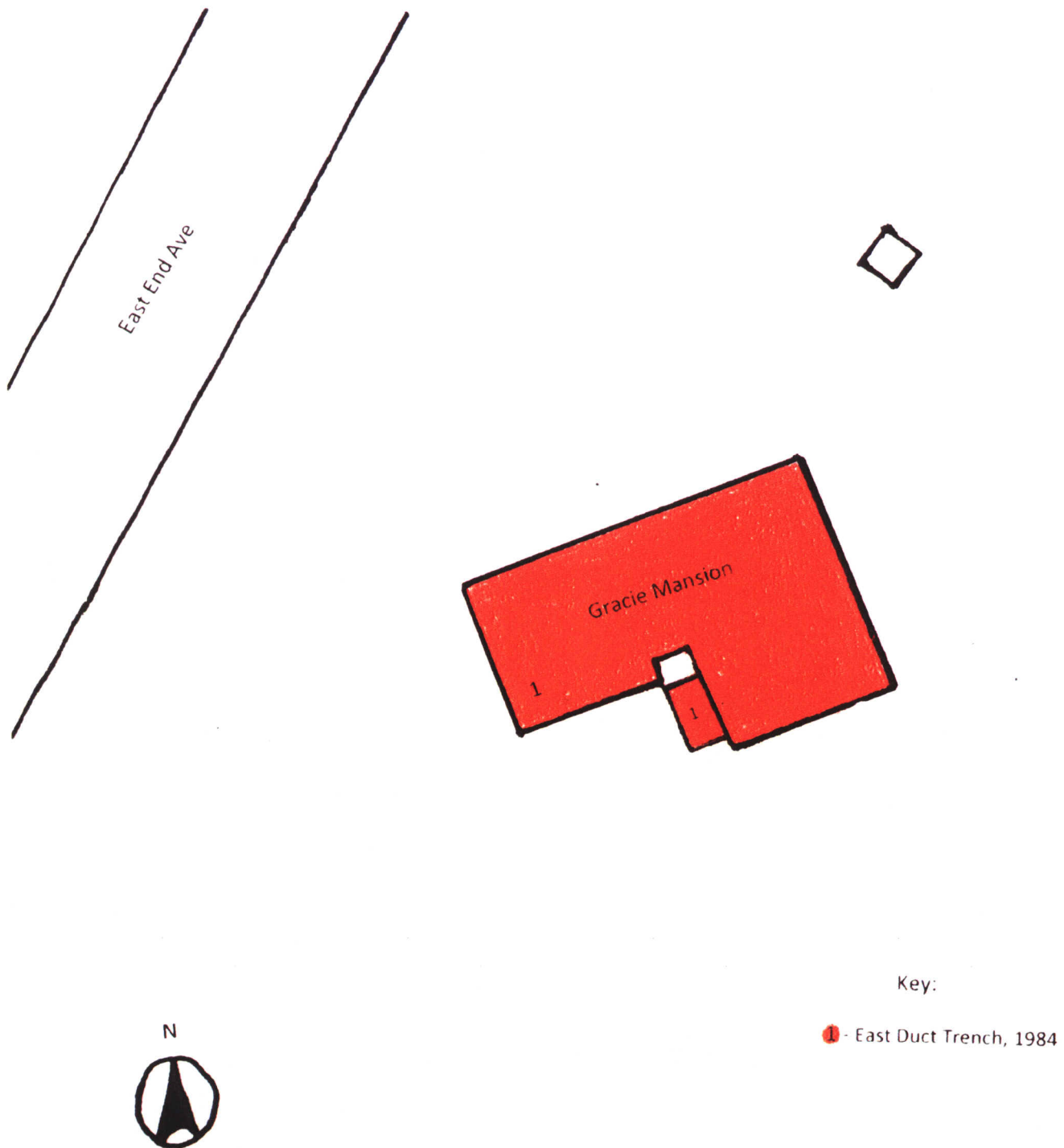

Figure 7: King Manor Archaeological Excavations Map (Rough Draft)

## King Manor Archaeological Excavations Map

**Key:**

- ① = Draft Report of 2004-2006 Archaeological Investigations at the Rufus King Manor Site, 2008
- ② = Scope of Work report for King Manor, 1997
- ③ = Phase 1b Archaeological Survey Report on the Northern Portion of Rufus King Park, Jamaica, Queens County, New York, 1990
- = Report on Archaeological Testing In Advance Of Improvements Associated With The Drainage and Termite Project At Rufus King Park Jamaica Avenue At 150-153 streets Jamaica Queens, New York Contract #Q023-195 and CNYG 497, 1998
- = Revised Scope of Work For Archaeological Testing In Advance Of Improvements At Rufus King Park, 1996
- ① = Rufus King Park Reconstruction Project - Phase 1B Field Archaeological Monitoring project, 2007
- = Tree Placement Monitoring, 2006

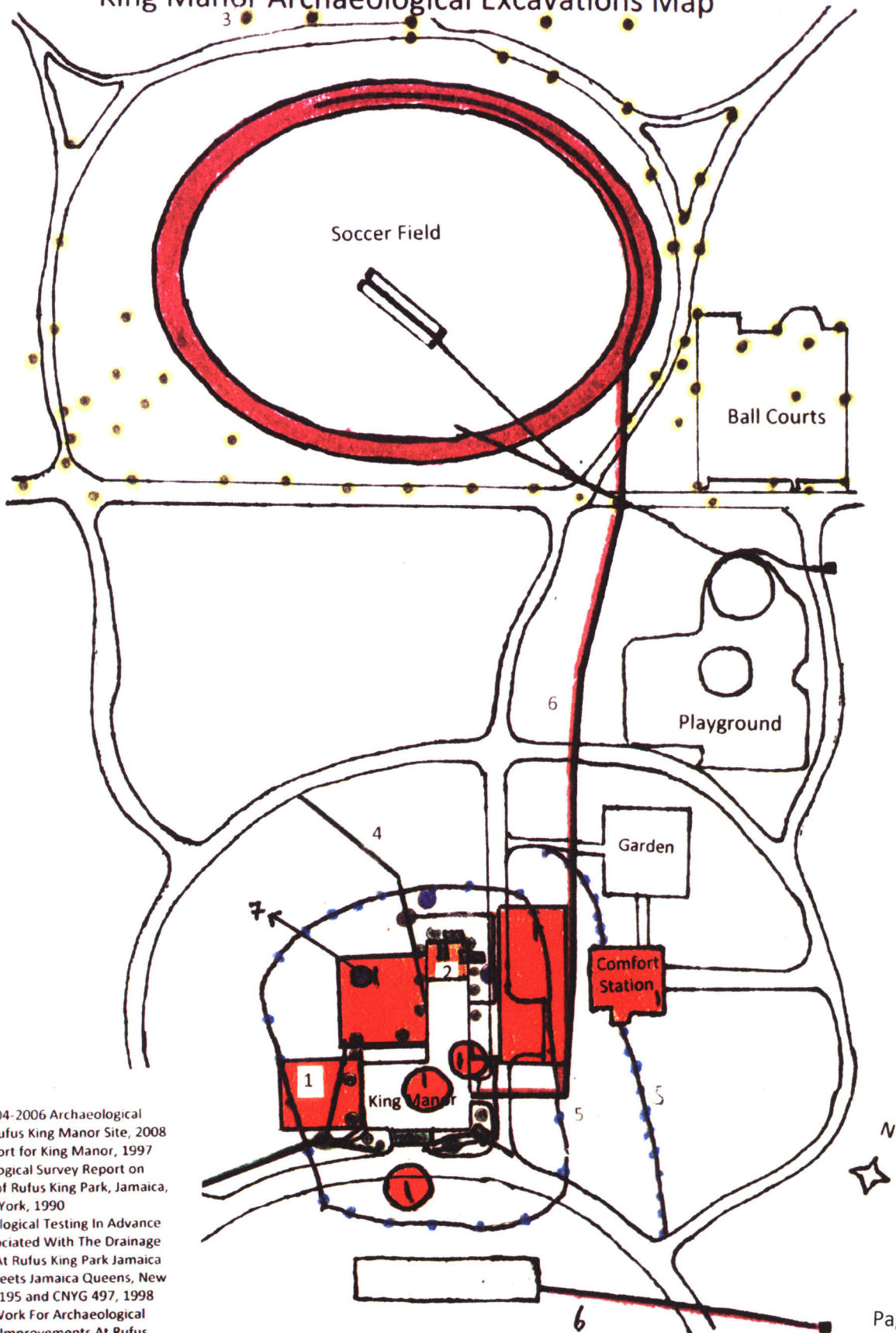
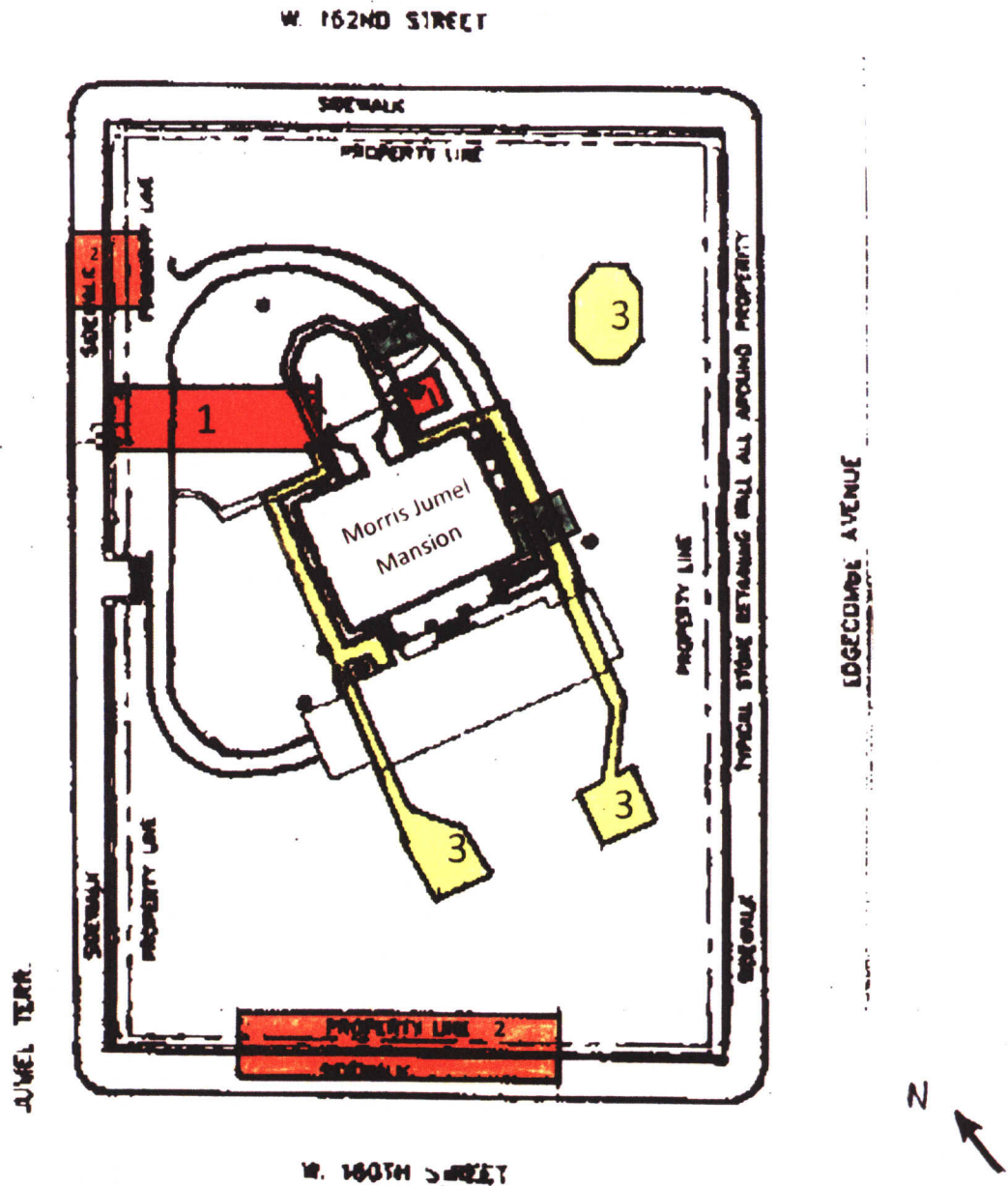

Figure 8: Morris-Jumel Mansion Archaeological Excavations Map (Rough Draft)

## Morris-Jumel Mansion Archaeological Excavations Map



**Key:**

- 1 = Report on Archaeological Testing in Advance of Fire Suppression Sprinkler Installation at the Morris-Jumel Mansion W 160th Street at Jumel Terrace Manhattan, New York Contract # M073-299, 2000
- 2 = Roger Morris Park (Morris Jumel Mansion) Emergency Cultural Resource Monitoring Project New York, New York Project #: M073-105M, 2005
- 3 = Archaeological Investigations Foundation Waterproofing Project Morris Jumel Mansion, 1994
- = A Report On The Archaeological Investigation At The Morris-Jumel Mansion, Washington Heights, New York City, 1986

• Not to Scale



# Queens County Farm Museum Archaeological Excavations Map

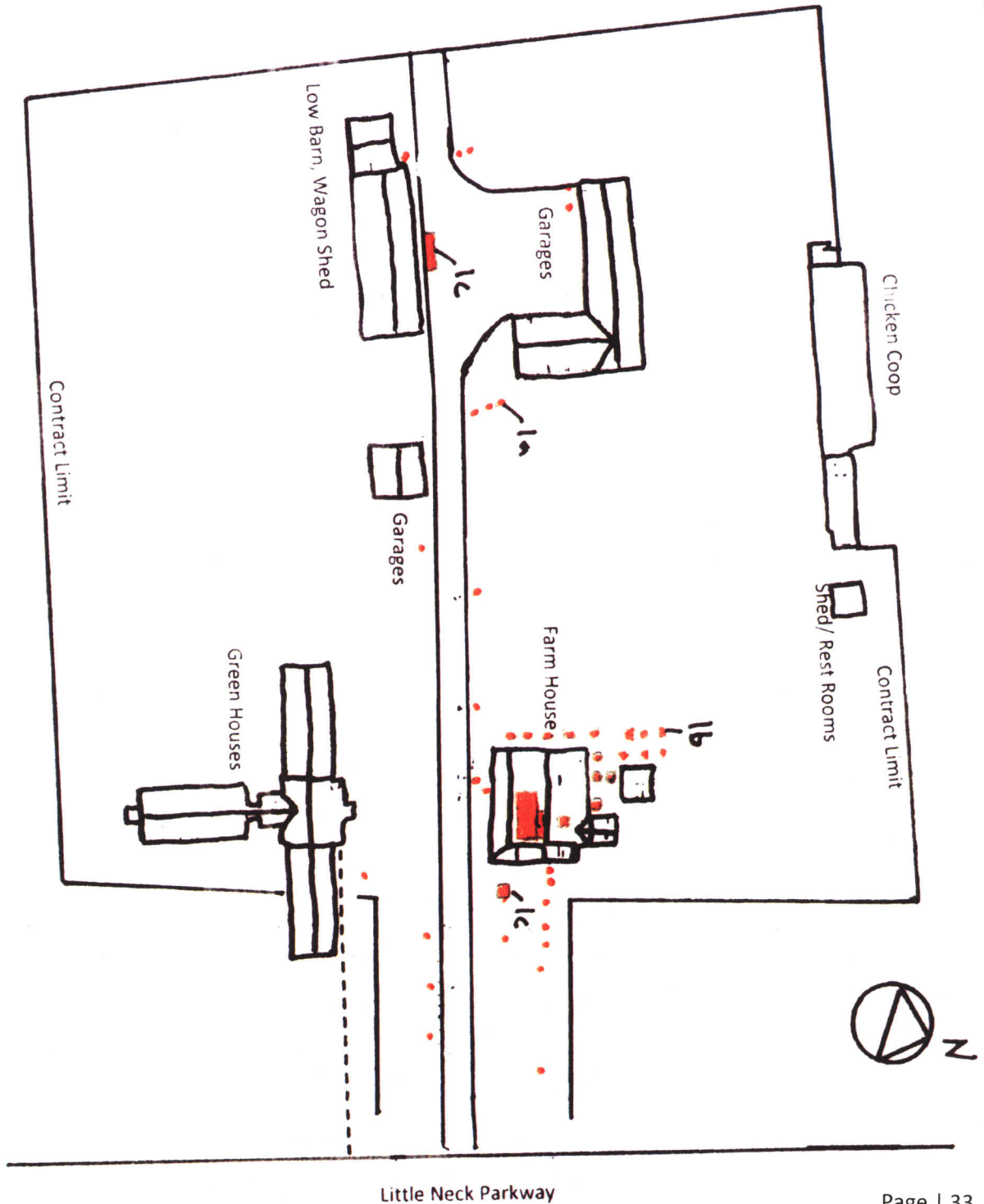

Figure 9: Queens County Farm Museum Archaeological Excavations Map (Rough Draft)

Key:

1 = Archaeological And Historical Study Adriance Farm Park, 1993

• Not to Scale. Based on a map by Louis Berger & Associates, 1985

# Van Cortlandt Mansion Archaeological Excavations Map

Figure 10: Van Cortlandt Mansion Archaeological Excavations Map (Rough Draft)

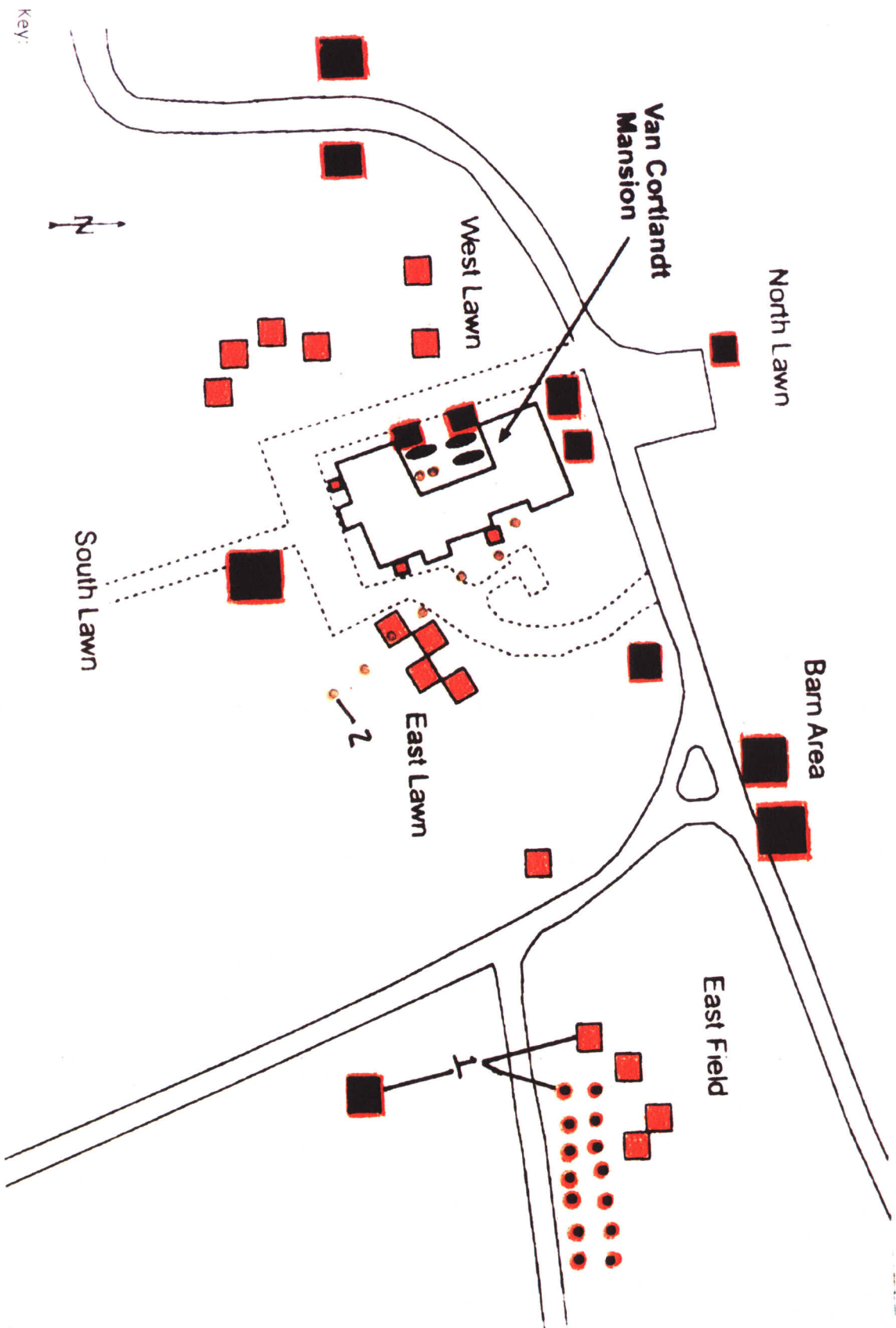

Figure 11: Wyckoff House Archaeological Excavations Map (Rough Draft)

# Wyckoff House Archaeological Excavations Map

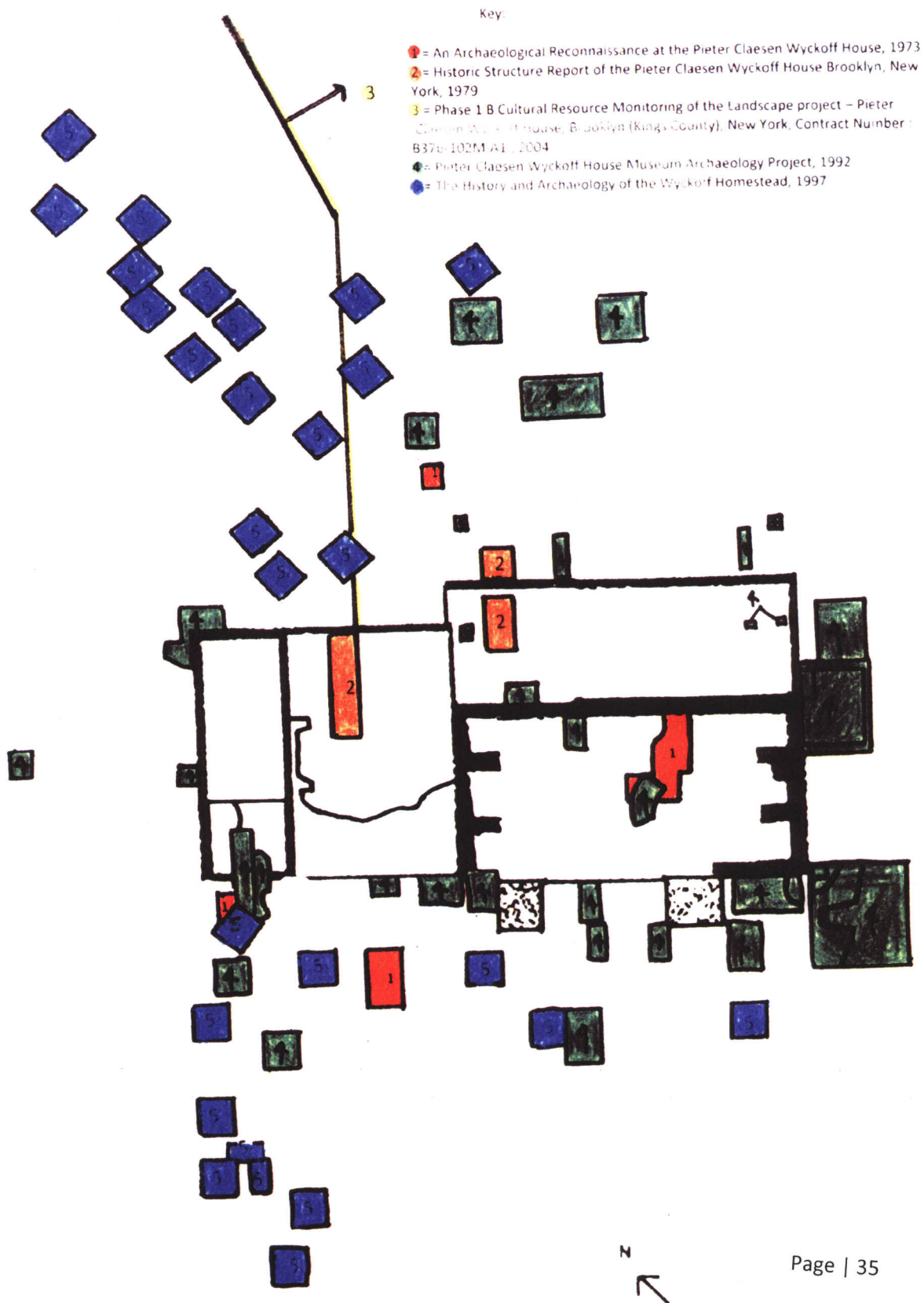

Figure 12: Suggested Database Organization

- I. Archaeological Documents
  - A. Articles
    - 1. Magazine Articles
    - 2. Newsletter Articles
    - 3. Newspaper Articles
  - B. Books
  - C. Correspondences
  - D. Environmental Reviews
  - E. Field Notes & Catalogs (i.e. Tables, Worksheets, Excavations Records etc)
  - F. Maps
  - G. Notes
  - H. Other
  - I. Photographs
  - J. Reports
    - 1. Archaeological Reports
      - a) Draft Reports
      - b) Final Reports
      - c) Sensitivity Reports
      - d) Summary Reports
    - 2. Historic Structures Reports



Figure 1B: Table of Document Frequency by House\*

HOUSE	# OF REPORTS
ALICE AUSTEN HOUSE	1
BARTOW-PELL MANSION	25
CONFERENCE HOUSE	27
DYCKMAN FARMHOUSE	12
GRACIE MANSION	35
KING MANOR	32
KINGSLAND HOMESTEAD	1
LOTT HOUSE	13
MERCHANT HOUSE MUSEUM	1
MORRIS JUMEL MANSION	8
QUEEN'S COUNTY FARM MUSEUM	11
HISTORIC RICHMOND TOWN	6
VAN CORTLNADT MANOR	112
WYCKOFF FARMHOUSE	36

- No archaeological documentation was found for the Bowne House, Edgar Allan Poe Cottage, Lefferts Historic House Museum, Lewis H. Latimer House, Little Red Lighthouse, Old Stone House, Sequine Mansion, Swedish Cottage Marionette Theatre, or the Valentine-Varian House.

Figure 2B: Chart of the Percentage of Documents by House

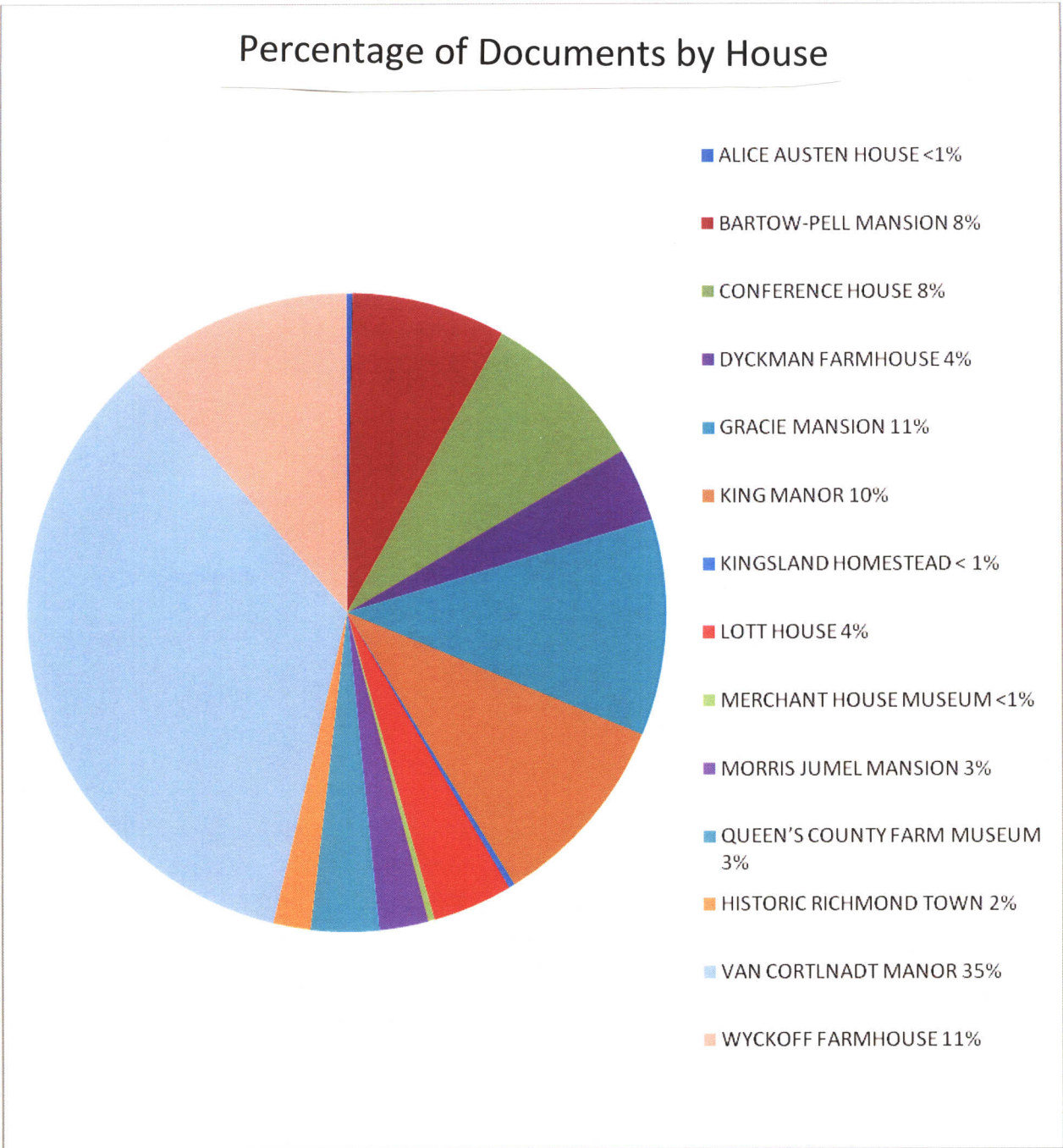
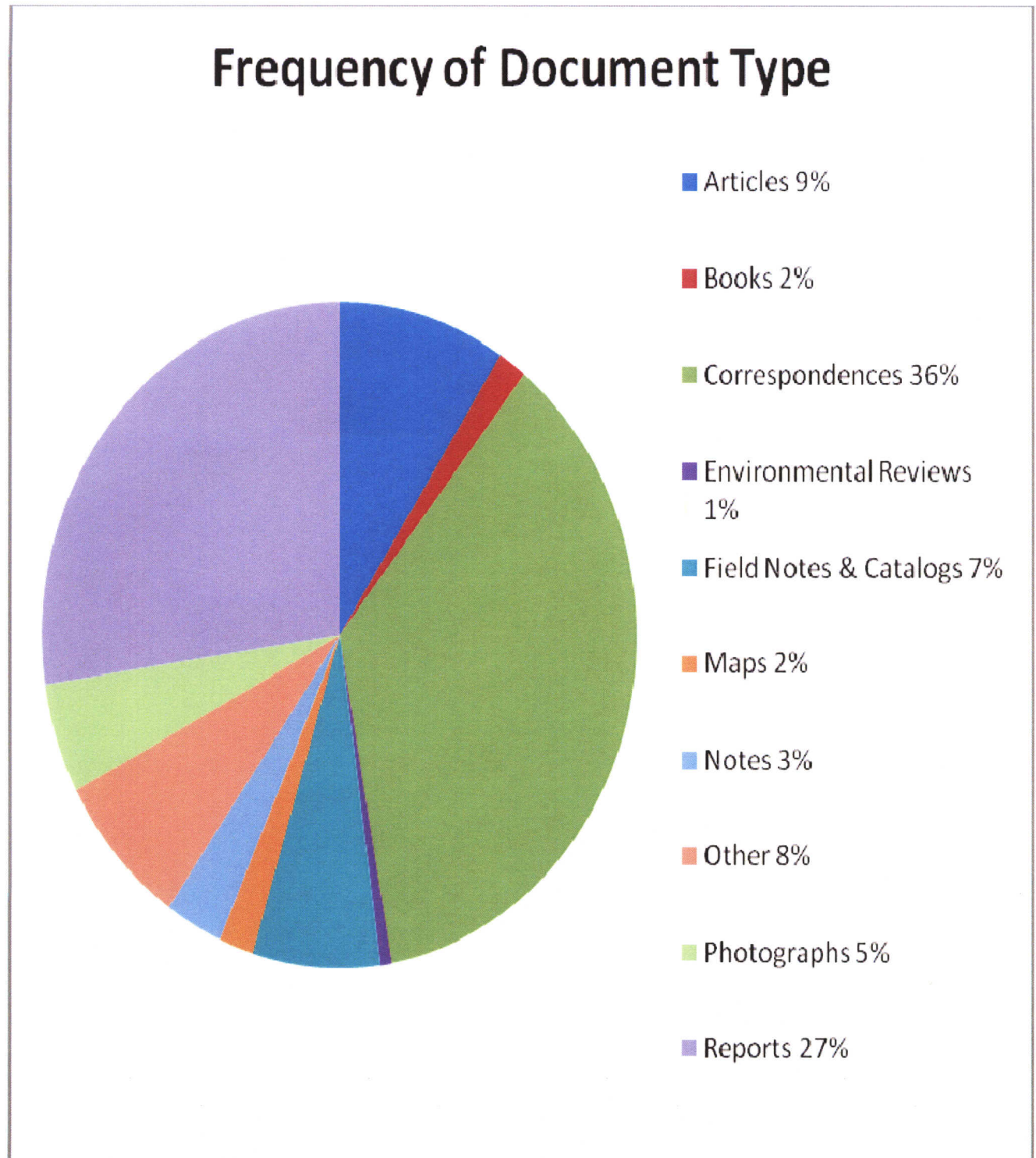

Figure 3B: Table of Document Type Frequency

Report Type	Frequency
Articles	29
Books	5
Correspondences	116
Environmental Reviews	2
Field Notes & Catalogs	22
Maps	6
Notes	10
Other	24
Photographs	17
Reports	87



Figure 4B: Chart of Document Type Frequency



## REFERENCES

Bankoff, H. Arthur. Personal interview. 2010.

H. Arthur Bankoff is the Chair of the Anthropology and Archaeology Department at Brooklyn College of the City University of New York. Bankoff has done archaeological work at the Bartow-Pell Mansion in the Bronx, the Hendrick I. Lott House in Brooklyn, and the Van Cortlandt Manor in the Bronx.

Berman, Marisa. E-mail interview. 2010.

Marisa Berman is the Executive Director of Kingsland Homestead in Queens.

Defillo, Carlotta. E-mail interview. 2010.

Carlotta Defillo is the Librarian for Historic Richmond Town in Staten Island.

Drabik, Caroline. Personal interview. 2010.

Caroline Drabik is the Collection's Manager for the Merchant's House Museum in Manhattan.

Ferlazzo, Joe. E-mail interview. 2010.

Joe Ferlazzo is the Staten Island Parks Borough Historian.

Fischetti-Boncardo, Amy. Personal interview. 2010.

Amy Fischetti-Boncardo is the Executive Director of the Queen's County Farm Museum.

Fowler, Susan. E-mail interview. 2010.

Susan Fowler is the former Office Administrator for the Conference House in Staten Island.

Friedman, Maxine. E-mail interview. 2010.

Maxine Friedman is the Chief Curator at Historic Richmond Town in Staten Island.

*Historic House Trust of New York City*. Parks Department. 830 5th Ave, The Arsenal, Rm.203, New York.

*Lanmark's Preservation Commission*. Web. <[www.nyc.gov/html/lpc/html/home/home.shtml](http://www.nyc.gov/html/lpc/html/home/home.shtml)>.

Matthews, Christopher N. E-mail interview. 2010.

Christopher N. Matthews has done archaeology at King Manor in Queens.

Mitchell, Gary. Personal interview. 2010.

Gary Mitchell is the Operations Manager for Queen's County Farm Museum.

Mronzinski, Mary Anne. Telephone interview. 2010.

Mary Anne Mronzinski is the Executive Director of King Manor in Queens.

*National Museum of the American Indian*. Web. 2010. <<http://www.nmai.si.edu/>>.

Emailed archivists, Michael and Jennifer, in regards to early archaeology in Staten Island.

*New York Public Library Catalog*. New York Public Library. Web. <[www.nypl.org](http://www.nypl.org)>.

Sorin, Meredith. Personal interview. 2010.

Meredith Sorin is the Deputy Director of the Historic House Trust of New York City.

Sutphin, Amanda. Personal interview. 2010.

Amanda Sutphin is the Director of Archaeology at the Landmark's Preservation Commission.

Toole, Diana. Personal interview. 2010.

Diana Toole works for the Gracie Mansion Conservancy.

Travisano, Mikel. Personal interview. 2010.

Mikel Travisano is the Architectural Conservator of the Historic House Trust of New York City.

Tseng, Nahn. Personal interview. 2010.

Nahn Tseng is the Senior Architectural Conservator of the Historic House Trust of New York City.

Vagnone, Franklin D. Personal interview. 2010.

Frank Vagone is the Executive Director of the Historic House Trust of New York City.

Williams, Bonnie A. E-mail interview. 2010.

Bonnie A. Williams is the Director of Conference House Park in Staten Island.